

DESCRIPTION	Usage	No.	Length	Mat.	Qty
U904475G550	TOPPLATE	001	5798	0.75	1
U904475G550	BOTPLATE	002	5798	0.75	1
U904475G550	NOGGING	003	4749	0.75	1
U904475G550	NOGGING	004	4749	0.75	1
U904475G550	HEAD	005	1072	0.75	1
U904475G550	NOGGING	006	119	0.75	2
C9075ra	STUD	100	3138	0.75	2
C9075ra	STUD	101	3096	0.75	8
C9075ra	STUD	102	2741	0.75	4
C9075ra	STUD	103	3096	0.75	1
C9075ra	STUD	104	3138	0.75	1
C9075ra	STUD	105	3096	0.75	1
C9075ra	STUD	106	3096	0.75	1
C9075ra	STUD	107	3138	0.75	1
BRA-1.0x30-550	Brace	201	3987	1.0	2
BRA-1.0x30-550	Brace	202	3751	1.0	2
C9075ra	WEB	203	666	0.75	1
C9075ra	WEB	204	774	0.75	2
MULTIGRIP	TIEDOWN	N/A		3	5
Washer40x40x5	HOLDDOWN	N/A		5	4
TENSIONER_SET	Tensnr	N/A	0	N/A	4
SCREW-12-14x20-HEX	SCREW	N/A	-	-	20
SCREW-M6-1PX18-TEK	SCREW	N/A	-	-	34
WALLTITE	SCREW	N/A	-	-	164

Length crib: 2
Floor RL: 0
INTERNAL wall

Screws at each end of BRA-1.0x30-550 = 3

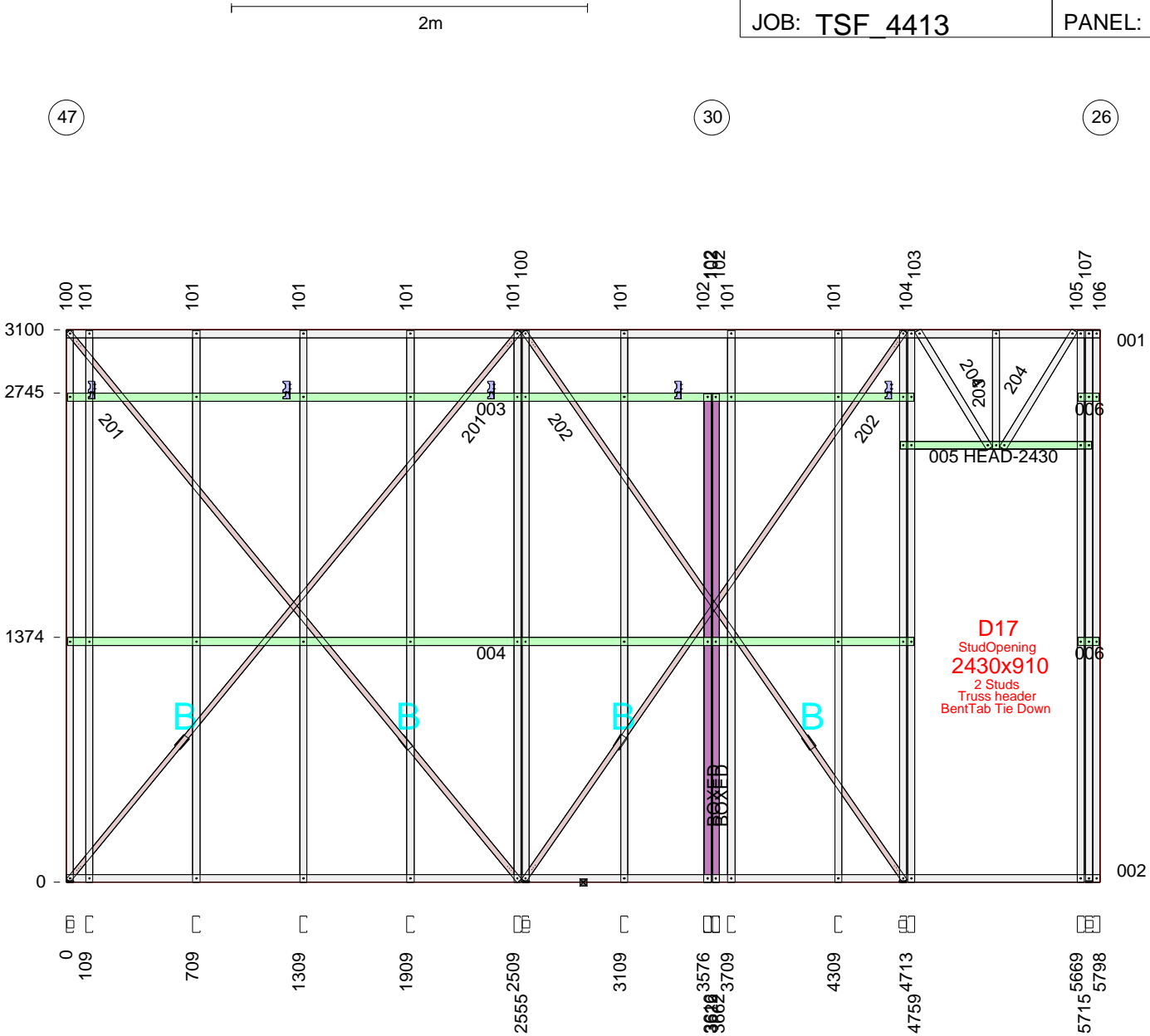

All dimensions to back of section. Where multiple lintels are used in place of a continuous lintel, it should have a minimum lap length of 450mm. Lintels should not be lapped over an opening.

ASSEMBLY DETAILS	OPENING DIMENSIONS (steel to steel)				PACKING DETAILS		LENGTH	MAX. HEIGHT
	ID	MANUF.	CAT NO.	UNIT DIM.	LEFT SIDE	RIGHT SIDE	5798	3100
ASSEMBLED:	D17	STUDOPEN	StudOpening	2430x910			DETAILER	DETAILED
FABRICATOR: TRUE STEEL FRAMES							VANTAGE_DS	21-10-2019
CUSTOMER: BERT FARINA CONSTRUCTION							WEIGHT	SCALE
CLIENT REF: 4 REDWOOD ST, ROSTREVOR							93	1:35

DESCRIPTION	Usage	No.	Length	Mat.	Qty
U904475G550	TOPPLATE	001	1528	0.75	1
U904475G550	BOTPLATE	002	1528	0.75	1
U904475G550	NOGGING	003	1518	0.75	1
U904475G550	NOGGING	004	1518	0.75	1
C9075ra	STUD	100	2783	0.75	1
C9075ra	STUD	101	393	0.75	1
C9075ra	STUD	102	3096	0.75	2
C9075ra	STUD	103	3138	0.75	1
BRA-1.0x30-550	Brace	201	3117	1.0	2
MULTIGRIP	TIEDOWN	N/A	3		2
TENSIONER_SET	Tensnr	N/A	0	N/A	2
Washer40x40x5	HOLDDOWN	N/A	5		2
SCREW-12-14x20-HEX	SCREW	N/A	-	-	8
SCREW-M6-1PX18-TEK	SCREW	N/A	-	-	16
WALLTITE	SCREW	N/A	-	-	34

Length crib: 2
Floor RL: 0
INTERNAL wall

Screws at each end of BRA-1.0x30-550 = 3

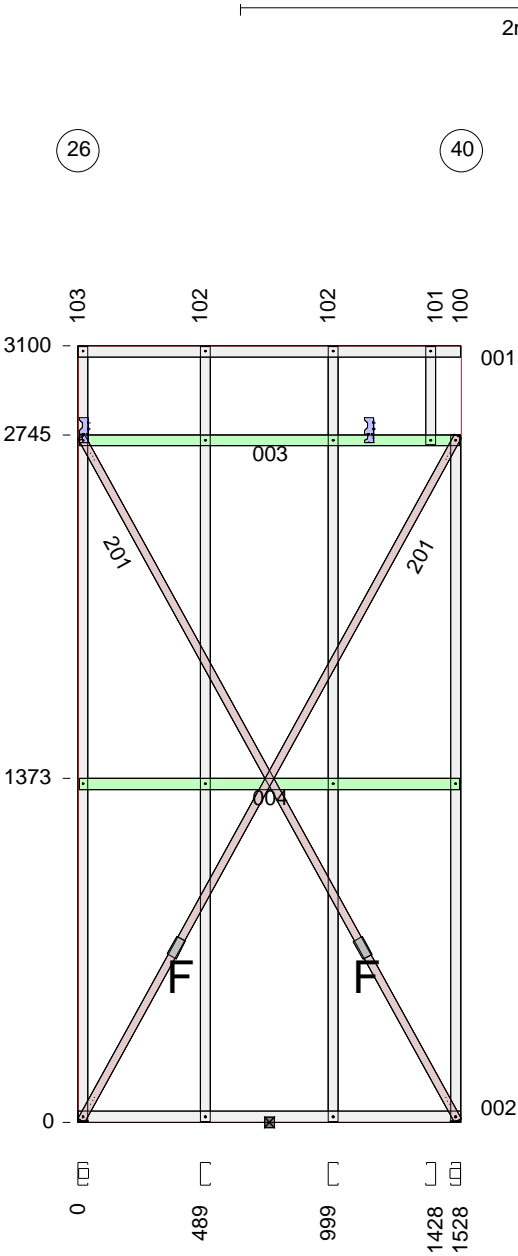

All dimensions to back of section. Where multiple lintels are used in place of a continuous lintel, it should have a minimum lap length of 450mm. Lintels should not be lapped over an opening.

ASSEMBLY DETAILS	OPENING DIMENSIONS (steel to steel)					PACKING DETAILS		LENGTH	MAX. HEIGHT
	ID	HEIGHT	WIDTH	HEAD	SILL	LEFT SIDE	RIGHT SIDE	1528	3100
ASSEMBLED: FABRICATOR: TRUE STEEL FRAMES CUSTOMER: BERT FARINA CONSTRUCTION CLIENT REF: 4 REDWOOD ST, ROSTREVOR								DETAILER	DETAILED
								VANTAGE_DS	21-10-2019
								WEIGHT	SCALE
								22	1:30

DESCRIPTION	Usage	No.	Length	Mat.	Qty
U904475G550	TOPPLATE	001	3178	0.75	1
U904475G550	BOTPLATE	002	3178	0.75	1
U904475G550	NOGGING	003	119	0.75	1
U904475G550	NOGGING	004	633	0.75	1
U904475G550	NOGGING	005	633	0.75	1
U904475G550	NOGGING	006	633	0.75	1
U904475G550	NOGGING	007	633	0.75	1
U904475G550	NOGGING	008	76	0.75	1
U904475G550	HEAD	009	2172	0.75	1
U904475G550	HEAD	010	2172	0.75	1
U904475G550	SILL	011	2172	0.75	1
U904475G550	HEAD	012	2430	0.75	1
U904475G550	NOGGING	013	288	0.75	1
C9075ra	STUD	100	3096	0.75	1
C9075ra	STUD	101	3138	0.75	1
C9075ra	STUD	102	3096	0.75	1
C9075ra	STUD	103	3138	0.75	1
C9075ra	STUD	104	851	0.75	3
C9075ra	STUD	105	1089	0.75	3
C9075ra	STUD	106	3138	0.75	1
C9075ra	STUD	107	3096	0.75	2
C9075ra	WEB	201	516	0.75	3
C9075ra	WEB	202	691	0.75	4
C9075ra	WEB	203	1154	0.75	2
C9075ra	WEB	204	1152	0.75	1
C9075ra	WEB	205	1152	0.75	1
MULTIGRIP	TIEDOWN	N/A		3	1
Washer40x40x5	HOLDDOWN	N/A		5	3
SCREW-12-14x20-HEX	SCREW	N/A	-	-	4
SCREW-M6-1PX18-TEK	SCREW	N/A	-	-	2
WALLTITE	SCREW	N/A	-	-	142

Length crib: 2
Floor RL: 0
INTERNAL wall

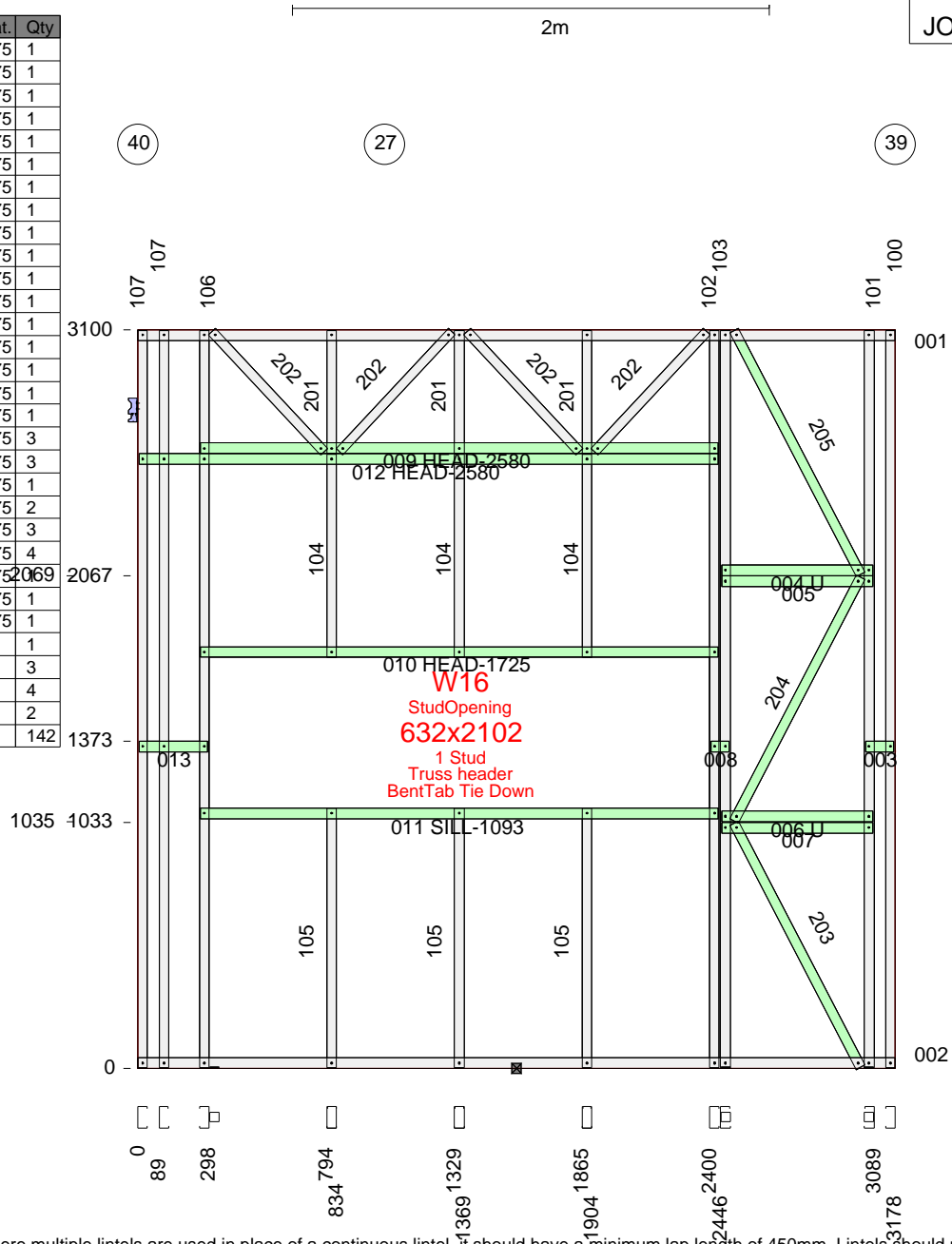

All dimensions to back of section. Where multiple lintels are used in place of a continuous lintel, it should have a minimum lap length of 450mm. Lintels should not be lapped over an opening.

ASSEMBLY DETAILS	OPENING DIMENSIONS (steel to steel)				PACKING DETAILS		LENGTH	MAX. HEIGHT
	ID	MANUF.	CAT NO.	UNIT DIM.	LEFT SIDE	RIGHT SIDE	3178	3100
ASSEMBLED: FABRICATOR: TRUE STEEL FRAMES CUSTOMER: BERT FARINA CONSTRUCTION CLIENT REF: 4 REDWOOD ST, ROSTREVOR	W16	STUDOPEN	StudOpening	632x2102			DETAILER	DETAILED
							VANTAGE_DS	21-10-2019
							WEIGHT	SCALE
							58	1:30

DESCRIPTION	Usage	No.	Length	Mat.	Qty
U904475G550	TOPPLATE	001	1618	0.75	1
U904475G550	BOTPLATE	002	1618	0.75	1
U904475G550	TOPPLATE	003	340	0.75	1
U904475G550	NOGGING	004	649	0.75	1
U904475G550	TOPPLATE	005	223	0.75	1
U904475G550	SILL	006	972	0.75	1
U904475G550	HEAD	007	972	0.75	1
U904475G550	NOGGING	008	139	0.75	1
C9075ra	STUD	100	3138	0.75	1
C9075ra	STUD	101	3138	0.75	1
C9075ra	STUD	102	3233	0.75	1
C9075ra	STUD	103	2741	0.75	1
C9075ra	STUD	104	3233	0.75	1
C9075ra	STUD	105	2587	0.75	1
C9075ra	STUD	106	177	0.75	1
C9075ra	STUD	107	2741	0.75	1
C9075ra	STUD	108	2587	0.75	1
C9075ra	STUD	109	2741	0.75	1
C15024	HEADER	N/A	898	2.4	1
Washer40x40x5	HOLDDOWN	N/A		5	4
WALLTITE	SCREW	N/A	-	-	78

Length crib: 2
Floor RL: 0
INTERNAL wall

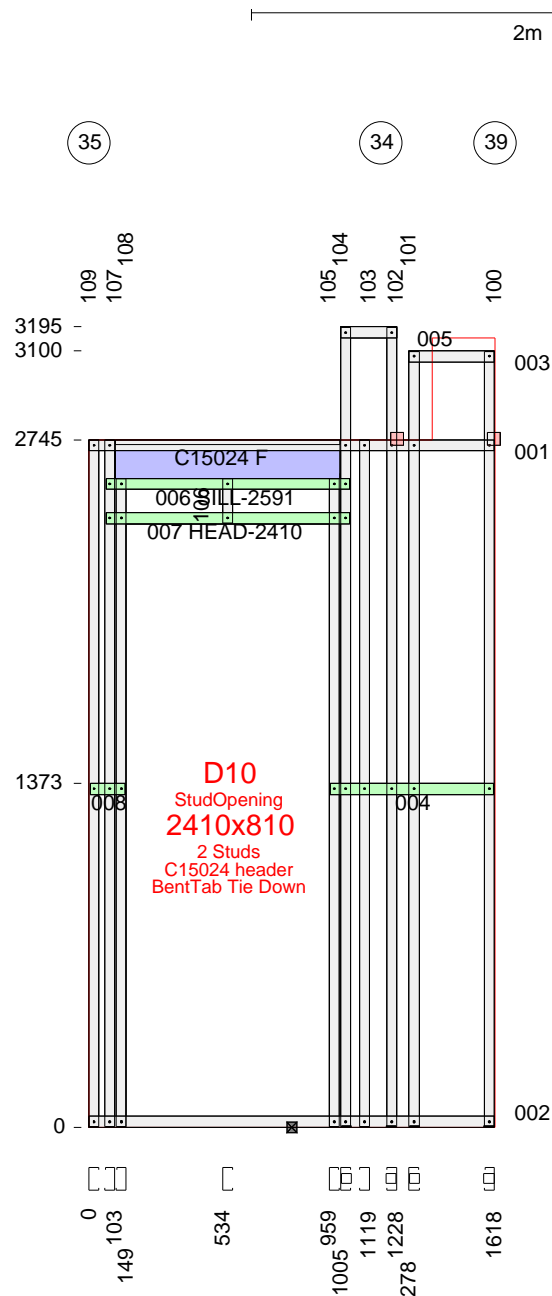

All dimensions to back of section. Where multiple lintels are used in place of a continuous lintel, it should have a minimum lap length of 450mm. Lintels should not be lapped over an opening.

ASSEMBLY DETAILS	OPENING DIMENSIONS (steel to steel)				PACKING DETAILS		LENGTH	MAX. HEIGHT
	ID	MANUF.	CAT NO.	UNIT DIM.	LEFT SIDE	RIGHT SIDE	1618	3150
ASSEMBLED:	D10	STUDOPEN	StudOpening	2410x810			DETAILER	DETAILED
FABRICATOR: TRUE STEEL FRAMES							VANTAGE_DS	21-10-2019
CUSTOMER: BERT FARINA CONSTRUCTION							WEIGHT	SCALE
CLIENT REF: 4 REDWOOD ST, ROSTREVOR							41	1:30

DESCRIPTION	Usage	No.	Length	Mat.	Qty
U904475G550	TOPPLATE	001	5578	0.75	1
U904475G550	BOTPLATE	002	5578	0.75	1
U904475G550	NOGGING	003	5568	0.75	1
U904475G550	TOPPLATE	004	130	0.75	1
C9075ra	STUD	100	2783	0.75	1
C9075ra	STUD	101	2741	0.75	11
C9075ra	STUD	102	3191	0.75	1
C9075ra	STUD	103	2783	0.75	3
C9075ra	STUD	104	3191	0.75	1
C9075ra	STUD	105	3191	0.75	1
BRA-1.0x30-550	Brace	201	3802	1.0	2
BRA-1.0x30-550	Brace	202	3686	1.0	2
TENSIONER_SET	Tensnr	N/A	0	N/A	4
Washer40x40x5	HOLDDOWN	N/A		5	4
SCREW-M6-1PX18-TEK	SCREW	N/A	-	-	24
WALLTITE	SCREW	N/A	-	-	112

Length crib: 2
Floor RL: 0
INTERNAL wall

Screws at each end of BRA-1.0x30-550 = 3

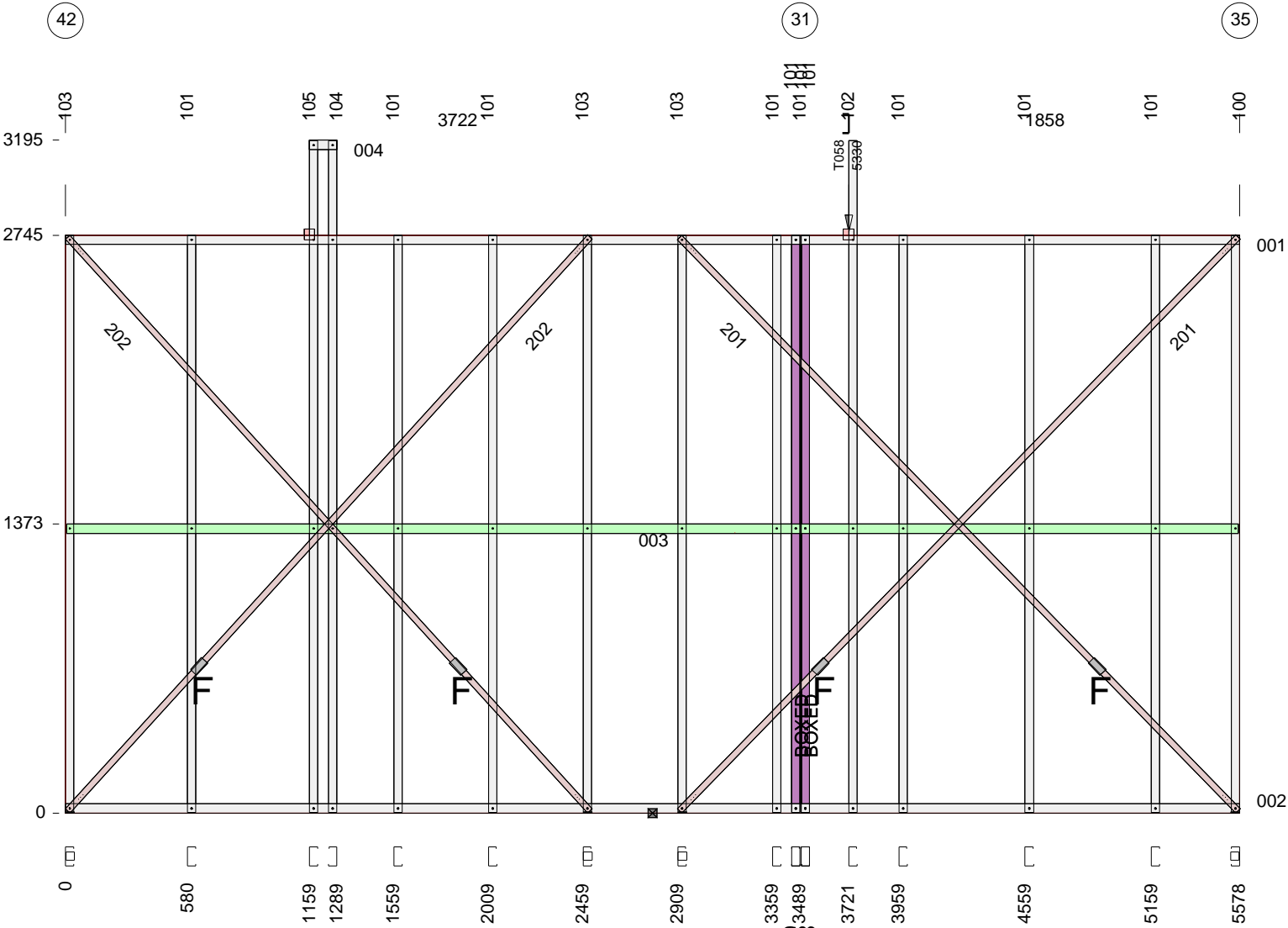

All dimensions to back of section. Where multiple lintels are used in place of a continuous lintel, it should have a minimum lap length of 450mm. Lintels should not be lapped over an opening.

ASSEMBLY DETAILS	OPENING DIMENSIONS (steel to steel)					PACKING DETAILS		LENGTH	MAX. HEIGHT
	ID	HEIGHT	WIDTH	HEAD	SILL	LEFT SIDE	RIGHT SIDE	5578	2745
ASSEMBLED:								DETAILER	DETAILED
FABRICATOR: TRUE STEEL FRAMES								VANTAGE_DS	21-10-2019
CUSTOMER: BERT FARINA CONSTRUCTION								WEIGHT	SCALE
CLIENT REF: 4 REDWOOD ST, ROSTREVOR								77	1:30

DESCRIPTION	Usage	No.	Length	Mat.	Qty
U904475G550	BOTPLATE	001	3298	0.75	1
U904475G550	NOGGING	002	3288	0.75	1
U904475G550	NOGGING	003	3288	0.75	1
U904475G550	TOPPLATE	004	3066	0.75	1
C9075ra	STUD	100	2783	0.75	1
C9075ra	STUD	101	3193	0.75	1
C9075ra	STUD	102	3235	0.75	5
C9075ra	STUD	103	3235	0.75	1
C9075ra	STUD	104	3235	0.75	1
C9075ra	STUD	105	3193	0.75	1
BRA-1.0x30-550	Brace	201	4197	1.0	2
MULTIGRIP	TIEDOWN	N/A	3		1
TENSIONER_SET	Tensnr	N/A	0	N/A	2
Washer40x40x5	HOLDDOWN	N/A	5		8
SCREW-12-14x20-HEX	SCREW	N/A	-	-	4
SCREW-M6-1PX18-TEK	SCREW	N/A	-	-	14
WALLTITE	SCREW	N/A	-	-	78

Length crib: 2
Floor RL: 0
INTERNAL wall

Screws at each end of BRA-1.0x30-550 = 3

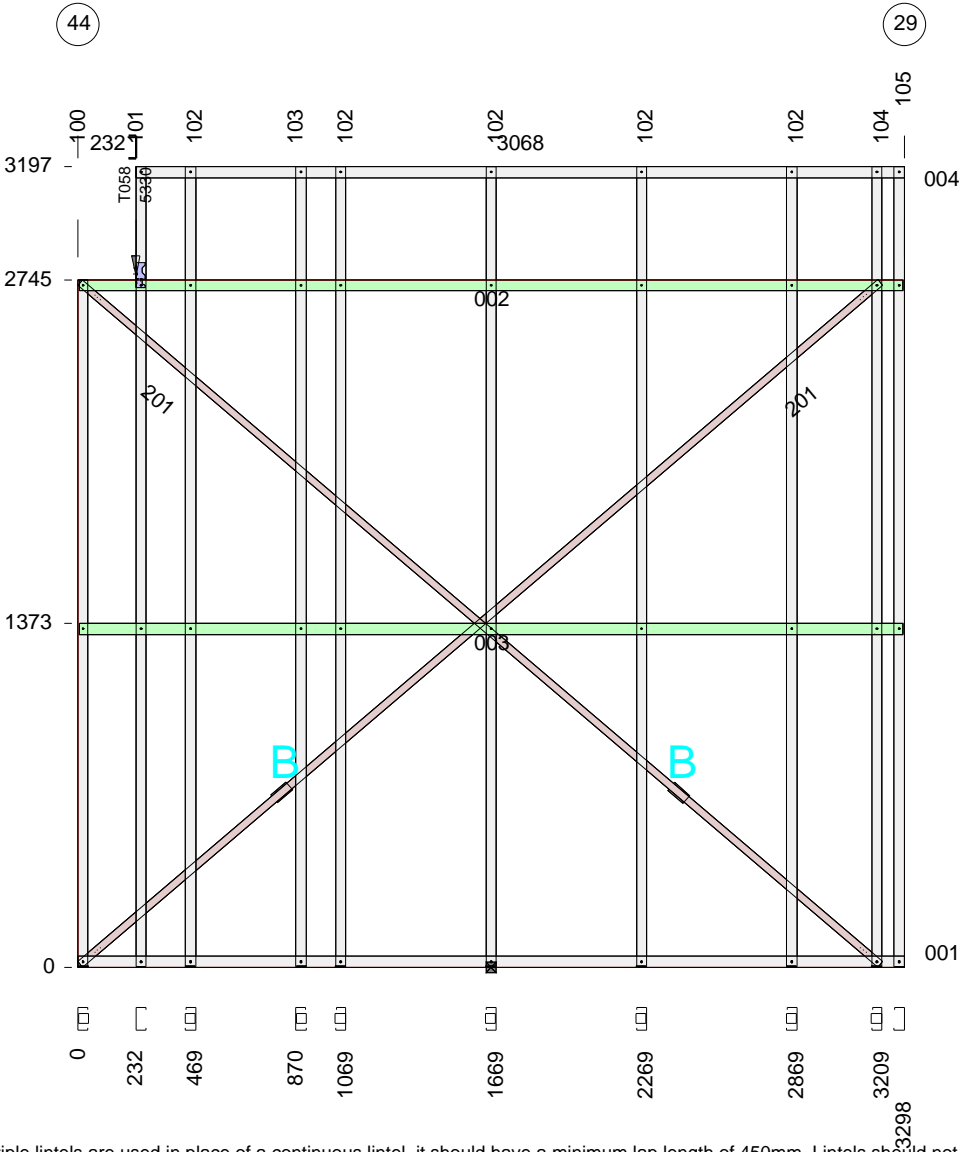

All dimensions to back of section. Where multiple lints are used in place of a continuous lintel, it should have a minimum lap length of 450mm. Lintels should not be lapped over an opening.

ASSEMBLY DETAILS	OPENING DIMENSIONS (steel to steel)					PACKING DETAILS		LENGTH	MAX. HEIGHT
	ID	HEIGHT	WIDTH	HEAD	SILL	LEFT SIDE	RIGHT SIDE	3298	3197
ASSEMBLED: FABRICATOR: TRUE STEEL FRAMES CUSTOMER: BERT FARINA CONSTRUCTION CLIENT REF: 4 REDWOOD ST, ROSTREVOR								DETAILER	DETAILED
								VANTAGE_DS	21-10-2019
								WEIGHT	SCALE
								51	1:30

DESCRIPTION	Usage	No.	Length	Mat.	Qty
U904475G550	BOTPLATE	001	5248	0.75	1
U904475G550	TOPPLATE	002	918	0.75	1
U904475G550	NOGGING	003	1674	0.75	1
U904475G550	TOPPLATE	004	1986	0.75	1
U904475G550	HEAD	005	1172	0.75	1
U904475G550	HEAD	006	1172	0.75	1
U904475G550	NOGGING	007	5238	0.75	1
U904475G550	NOGGING	008	460	0.75	1
U904475G550	HEAD	009	1809	0.75	1
U904475G550	TOPPLATE	010	2145	0.75	1
U904475G550	NOGGING	011	427	0.75	1
C9075ra	STUD	100	3235	0.75	2
C9075ra	STUD	101	3235	0.75	1
C9075ra	STUD	102	3193	0.75	3
C9075ra	STUD	103	3193	0.75	1
C9075ra	STUD	104	566	0.75	1
C9075ra	STUD	105	3235	0.75	1
C9075ra	STUD	106	2471	0.75	1
C9075ra	STUD	107	566	0.75	1
C9075ra	STUD	108	566	0.75	1
C9075ra	STUD	109	3235	0.75	1
C9075ra	STUD	110	2471	0.75	1
C9075ra	STUD	111	490	0.75	1
C9075ra	STUD	112	3193	0.75	1
C9075ra	STUD	113	3235	0.75	1
C9075ra	STUD	114	773	0.75	2
C9075ra	STUD	115	3193	0.75	1
C9075ra	STUD	116	3235	0.75	1
C9075ra	STUD	117	2741	0.75	1
C9075ra	WEB	201	588	0.75	2
C9075ra	WEB	202	588	0.75	1
C9075ra	STIFFENER	300	1006	0.75	1
Hardibrace_5mm	PanelBrace	N/A	2741	5	1
C15010	HEADER	N/A	1098	1	1
Washer40x40x5	HOLDDOWN	N/A		5	8
WALLTITE	SCREW	N/A	-	-	190

Length crib: 2
Floor RL: 0
INTERNAL wall

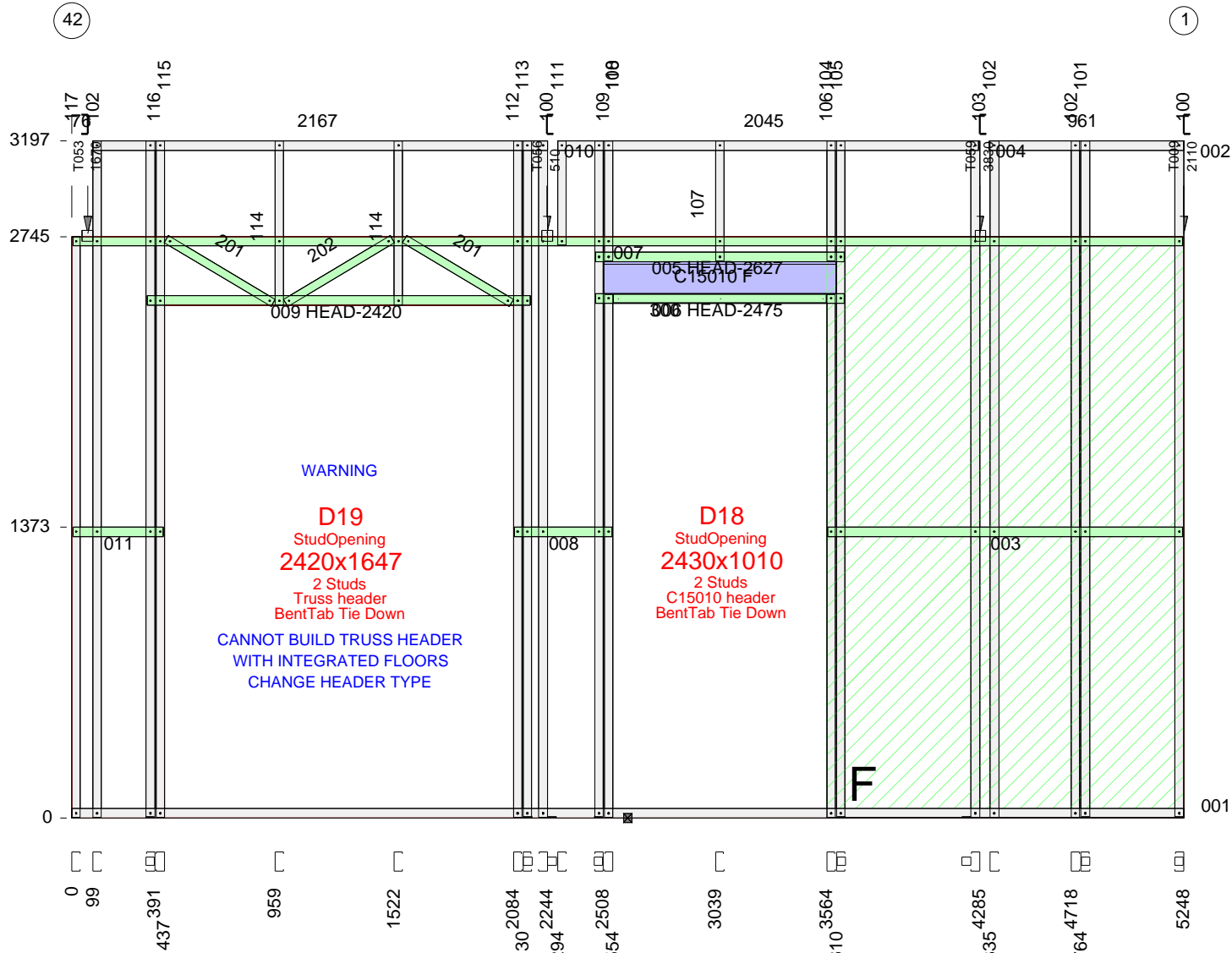

All dimensions to back of section. Where multiple lintels are used in place of a continuous lintel, it should have a minimum lap length of 450mm. Lintels should not be lapped over an opening.

ASSEMBLY DETAILS	OPENING DIMENSIONS (steel to steel)				PACKING DETAILS		LENGTH	MAX. HEIGHT
	ID	MANUF.	CAT NO.	UNIT DIM.	LEFT SIDE	RIGHT SIDE	5248	3197
ASSEMBLED: FABRICATOR: TRUE STEEL FRAMES CUSTOMER: BERT FARINA CONSTRUCTION CLIENT REF: 4 REDWOOD ST, ROSTREVOR	D18	STUDOPEN	StudOpening	2430x1010			DETAILER	DETAILED
	D19	STUDOPEN	StudOpening	2420x1647			VANTAGE_DS	21-10-2019
							WEIGHT	SCALE
							118	1:30

DESCRIPTION	Usage	No.	Length	Mat.	Qty
U904475G550	TOPPLATE	001	1518	0.75	1
U904475G550	BOTPLATE	002	1518	0.75	1
U904475G550	NOGGING	003	614	0.75	1
U904475G550	TOPPLATE	004	198	0.75	1
U904475G550	SILL	005	970	0.75	1
U904475G550	HEAD	006	970	0.75	1
U904475G550	NOGGING	007	74	0.75	1
C9075ra	STUD	100	2741	0.75	1
C9075ra	STUD	101	3191	0.75	1
C9075ra	STUD	102	2741	0.75	1
C9075ra	STUD	103	3233	0.75	1
C9075ra	STUD	104	2587	0.75	1
C9075ra	STUD	105	177	0.75	1
C9075ra	STUD	106	2783	0.75	1
C9075ra	STUD	107	2587	0.75	1
C15015	HEADER	N/A	896	1.5	1
Washer40x40x5	HOLDDOWN	N/A		5	2
WALLTITE	SCREW	N/A	-	-	62

Length crib: 2
Floor RL: 0
INTERNAL wall

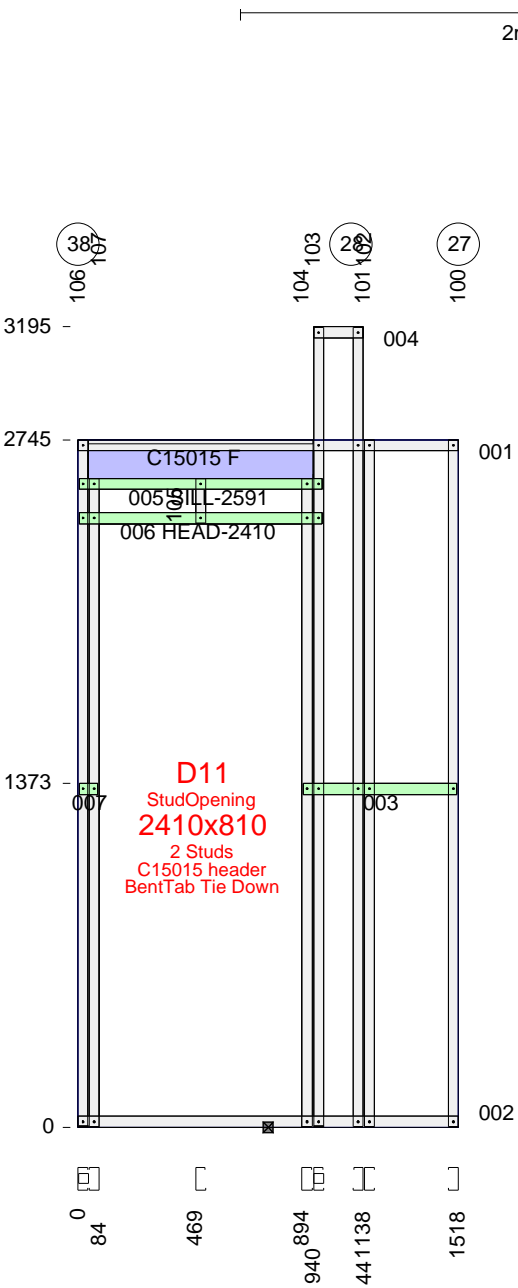

All dimensions to back of section. Where multiple lintels are used in place of a continuous lintel, it should have a minimum lap length of 450mm. Lintels should not be lapped over an opening.

ASSEMBLY DETAILS	OPENING DIMENSIONS (steel to steel)				PACKING DETAILS		LENGTH	MAX. HEIGHT
	ID	MANUF.	CAT NO.	UNIT DIM.	LEFT SIDE	RIGHT SIDE	1518	2745
ASSEMBLED:	D11	STUDOPEN	StudOpening	2410x810			DETAILER	DETAILED
FABRICATOR: TRUE STEEL FRAMES							VANTAGE_DS	21-10-2019
CUSTOMER: BERT FARINA CONSTRUCTION							WEIGHT	SCALE
CLIENT REF: 4 REDWOOD ST, ROSTREVOR							31	1:30

DESCRIPTION	Usage	No.	Length	Mat.	Qty
U904475G550	TOPPLATE	001	2998	0.75	1
U904475G550	BOTPLATE	002	2998	0.75	1
U904475G550	NOGGING	003	2139	0.75	1
U904475G550	TOPPLATE	004	246	0.75	1
U904475G550	HEAD	005	879	0.75	1
C9075ra	STUD	100	2783	0.75	1
C9075ra	STUD	101	2783	0.75	2
C9075ra	STUD	102	2741	0.75	2
C9075ra	STUD	103	3233	0.75	1
C9075ra	STUD	104	3191	0.75	1
C9075ra	STUD	105	2741	0.75	1
C9075ra	STUD	106	2741	0.75	1
C9075ra	STUD	107	331	0.75	1
C9075ra	STUD	108	2783	0.75	1
BRA-1.0x30-550	Brace	201	3293	1.0	4
U904475G550	PACKER	800	2361	0.75	1
TENSIONER_SET	Tensnr	N/A	0	N/A	4
Washer40x40x5	HOLDDOWN	N/A	-	5	5
SCREW-M6-1PX18-TEK	SCREW	N/A	-	-	24
WALLTITE	SCREW	N/A	-	-	70

Length crib: 2
Floor RL: 0
INTERNAL wall

Screws at each end of BRA-1.0x30-550 = 3

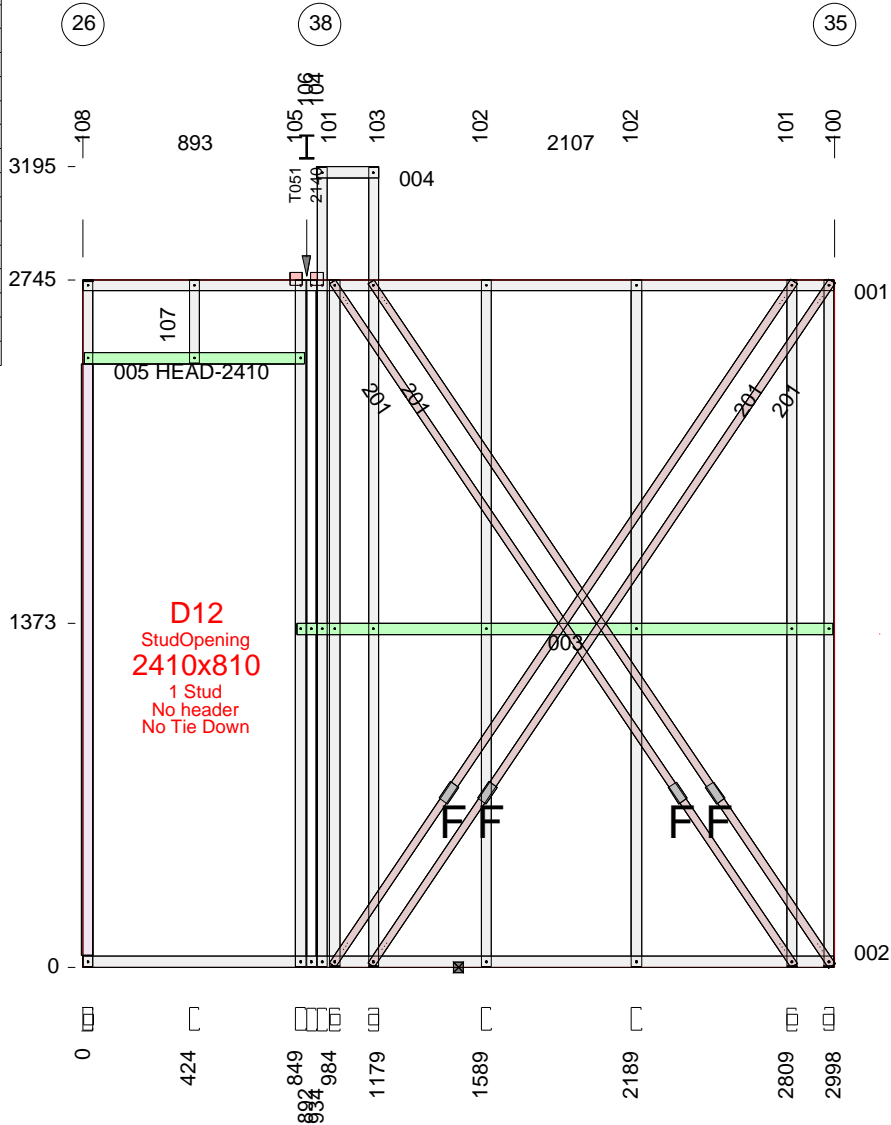

All dimensions to back of section. Where multiple lintels are used in place of a continuous lintel, it should have a minimum lap length of 450mm. Lintels should not be lapped over an opening.

ASSEMBLY DETAILS	OPENING DIMENSIONS (steel to steel)				PACKING DETAILS		LENGTH	MAX. HEIGHT
	ID	MANUF.	CAT NO.	UNIT DIM.	LEFT SIDE	RIGHT SIDE	2998	2745
ASSEMBLED:	D12	STUDOPEN	StudOpening	2410x810			DETAILER	DETAILED
FABRICATOR: TRUE STEEL FRAMES							VANTAGE_DS	21-10-2019
CUSTOMER: BERT FARINA CONSTRUCTION							WEIGHT	SCALE
CLIENT REF: 4 REDWOOD ST, ROSTREVOR							47	1:30

DESCRIPTION	Usage	No.	Length	Mat.	Qty
U904475G550	TOPPLATE	001	918	0.75	1
U904475G550	BOTPLATE	002	918	0.75	1
U904475G550	NOGGING	003	908	0.75	1
C9075ra	STUD	100	2783	0.75	1
C9075ra	STUD	101	2741	0.75	1
C9075ra	STUD	102	2783	0.75	1
Hardibrace_5mm	PanelBrace	N/A	2741	5	1
Washer40x40x5	HOLDDOWN	N/A		5	2
WALLTITE	SCREW	N/A	-	-	18

Length crib: 2
Floor RL: 0
INTERNAL wall

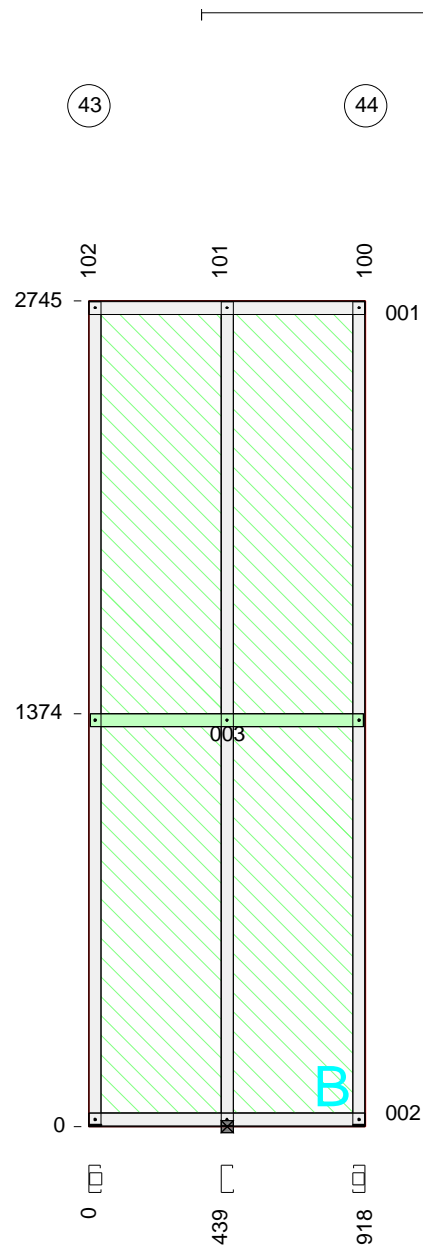

All dimensions to back of section. Where multiple lintels are used in place of a continuous lintel, it should have a minimum lap length of 450mm. Lintels should not be lapped over an opening.

ASSEMBLY DETAILS	OPENING DIMENSIONS (steel to steel)					PACKING DETAILS		LENGTH	MAX. HEIGHT
	ID	HEIGHT	WIDTH	HEAD	SILL	LEFT SIDE	RIGHT SIDE	918	2745
ASSEMBLED: FABRICATOR: TRUE STEEL FRAMES CUSTOMER: BERT FARINA CONSTRUCTION CLIENT REF: 4 REDWOOD ST, ROSTREVOR								DETAILER	DETAILED
								VANTAGE_DS	21-10-2019
								WEIGHT	SCALE
								29	1:25

DESCRIPTION	Usage	No.	Length	Mat.	Qty
U904475G550	TOPPLATE	001	2578	0.75	1
U904475G550	BOTPLATE	002	2578	0.75	1
U904475G550	NOGGING	003	119	0.75	1
U904475G550	HEAD	004	880	0.75	1
U904475G550	NOGGING	005	1629	0.75	1
C9075ra	STUD	100	2741	0.75	1
C9075ra	STUD	101	2741	0.75	1
C9075ra	STUD	102	331	0.75	1
C9075ra	STUD	103	2783	0.75	1
C9075ra	STUD	104	2741	0.75	3
C9075ra	STUD	105	2783	0.75	1
BRA-1.0x30-550	Brace	201	3128	1.0	2
TENSIONER_SET	Tensnr	N/A	0	N/A	2
Washer40x40x5	HOLDDOWN	N/A		5	2
SCREW-M6-1PX18-TEK	SCREW	N/A	-	-	12
WALLTITE	SCREW	N/A	-	-	50

Length crib: 2
Floor RL: 0
INTERNAL wall

Screws at each end of BRA-1.0x30-550 = 3

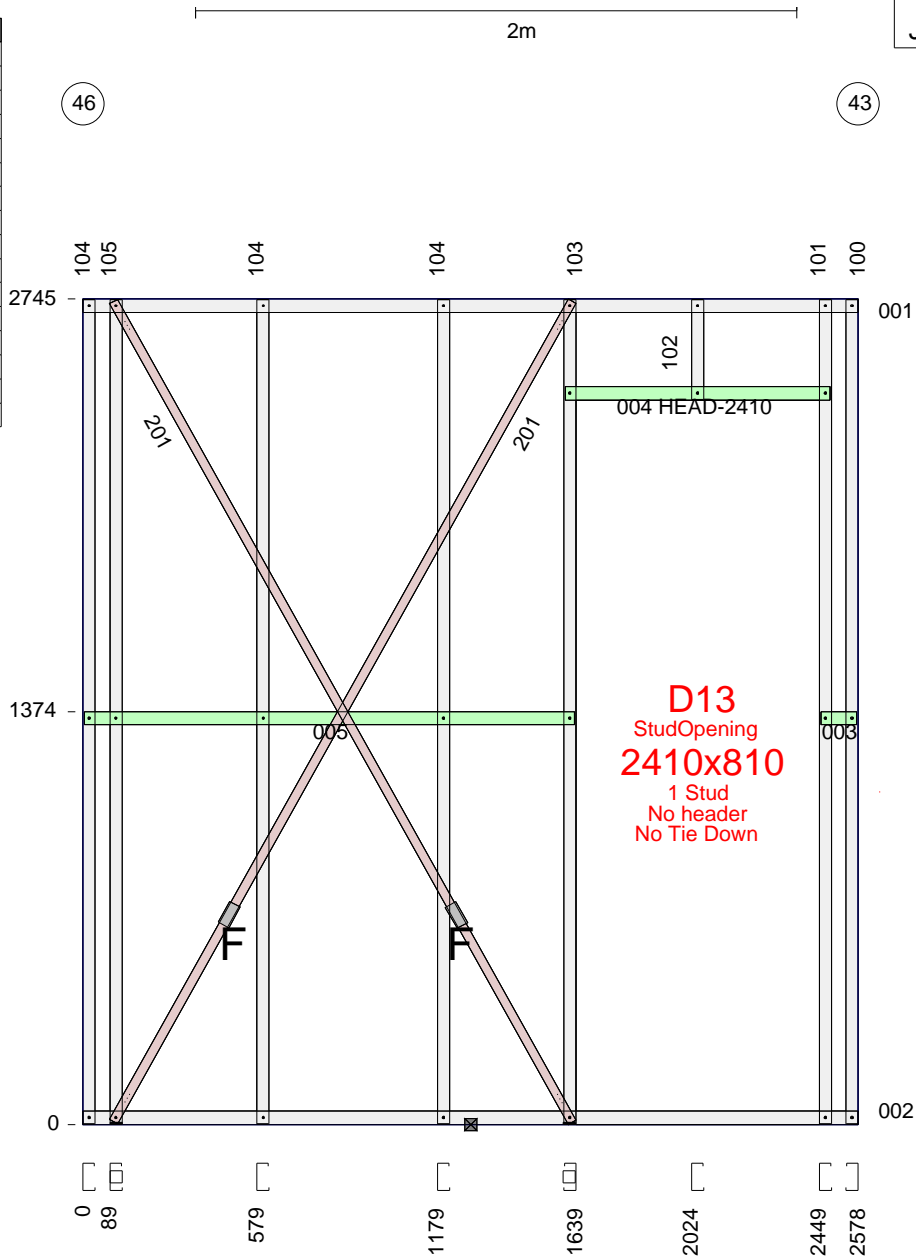

All dimensions to back of section. Where multiple lintels are used in place of a continuous lintel, it should have a minimum lap length of 450mm. Lintels should not be lapped over an opening.

ASSEMBLY DETAILS	OPENING DIMENSIONS (steel to steel)				PACKING DETAILS		LENGTH	MAX. HEIGHT
	ID	MANUF.	CAT NO.	UNIT DIM.	LEFT SIDE	RIGHT SIDE	2578	2745
ASSEMBLED:	D13	STUDOPEN	StudOpening	2410x810			DETAILER	DETAILED
FABRICATOR: TRUE STEEL FRAMES							VANTAGE_DS	21-10-2019
CUSTOMER: BERT FARINA CONSTRUCTION							WEIGHT	SCALE
CLIENT REF: 4 REDWOOD ST, ROSTREVOR							31	1:25

DESCRIPTION	Usage	No.	Length	Mat.	Qty
U904475G550	TOPPLATE	001	918	0.75	1
U904475G550	BOTPLATE	002	918	0.75	1
C9075ra	STUD	100	596	0.75	1
C9075ra	STUD	101	596	0.75	2
WALLTITE	SCREW	N/A	-	-	12

Length crib: 2
Floor RL: 0
INTERNAL wall

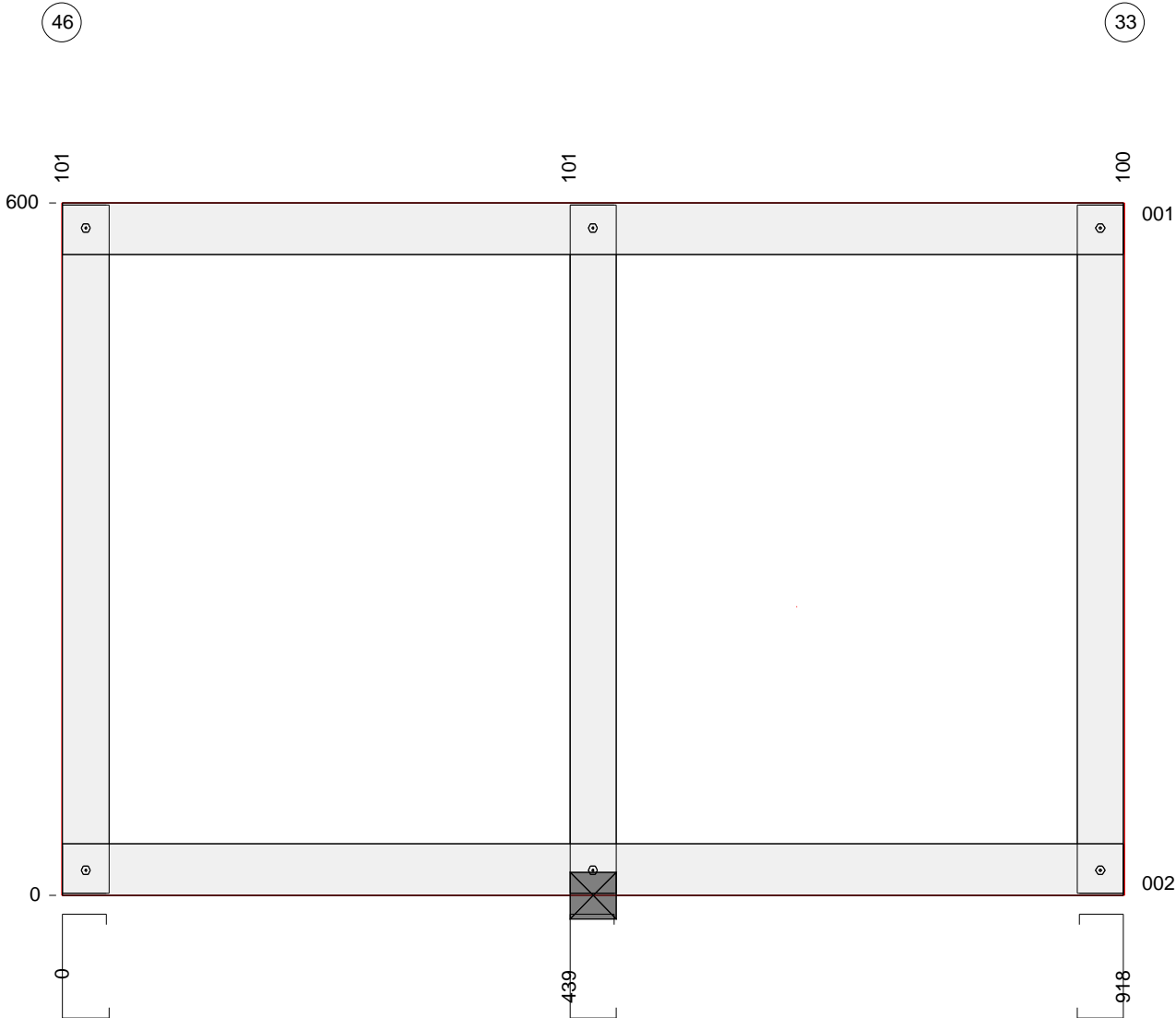

All dimensions to back of section. Where multiple lintels are used in place of a continuous lintel, it should have a minimum lap length of 450mm. Lintels should not be lapped over an opening.

ASSEMBLY DETAILS	OPENING DIMENSIONS (steel to steel)					PACKING DETAILS		LENGTH	MAX. HEIGHT
	ID	HEIGHT	WIDTH	HEAD	SILL	LEFT SIDE	RIGHT SIDE	918	600
ASSEMBLED: FABRICATOR: TRUE STEEL FRAMES CUSTOMER: BERT FARINA CONSTRUCTION CLIENT REF: 4 REDWOOD ST, ROSTREVOR								DETAILER	DETAILED
								VANTAGE_DS	21-10-2019
								WEIGHT	SCALE
								4	1:6

DESCRIPTION	Usage	No.	Length	Mat.	Qty
U904475G550	TOPPLATE	001	1688	0.75	1
U904475G550	BOTPLATE	002	1688	0.75	1
U904475G550	TOPPLATE	003	899	0.75	1
U904475G550	NOGGING	004	1678	0.75	1
C9075ra	STUD	100	2862	0.75	1
C9075ra	STUD	101	2783	0.75	1
C9075ra	STUD	102	2862	0.75	1
C9075ra	STUD	103	2862	0.75	1
C9075ra	STUD	104	2741	0.75	1
C9075ra	STUD	105	2783	0.75	1
BRA-1.0x30-550	Brace	201	3152	1.0	2
TENSIONER_SET	Tensnr	N/A	0	N/A	2
Washer40x40x5	HOLDDOWN	N/A		5	2
SCREW-M6-1PX18-TEK	SCREW	N/A	-	-	12
WALLTITE	SCREW	N/A	-	-	42

Length crib: 2
Floor RL: 3217
INTERNAL wall

Screws at each end of BRA-1.0x30-550 = 3

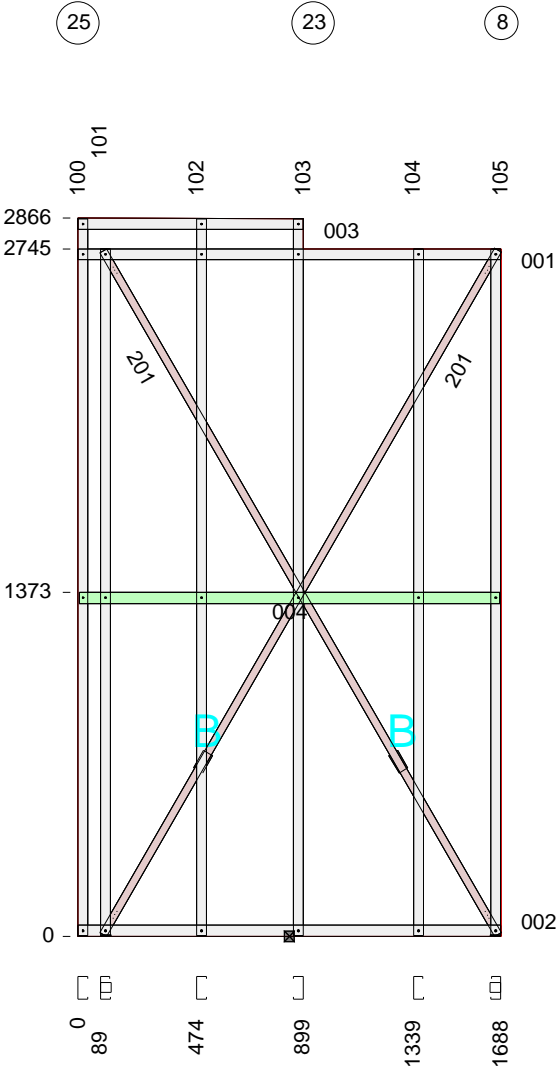

All dimensions to back of section. Where multiple lintels are used in place of a continuous lintel, it should have a minimum lap length of 450mm. Lintels should not be lapped over an opening.

ASSEMBLY DETAILS	OPENING DIMENSIONS (steel to steel)					PACKING DETAILS		LENGTH	MAX. HEIGHT
	ID	HEIGHT	WIDTH	HEAD	SILL	LEFT SIDE	RIGHT SIDE	1688	2866
ASSEMBLED: FABRICATOR: TRUE STEEL FRAMES CUSTOMER: BERT FARINA CONSTRUCTION CLIENT REF: 4 REDWOOD ST, ROSTREVOR								DETAILER	DETAILED
								VANTAGE_DS	21-10-2019
								WEIGHT	SCALE
								26	1:30

DESCRIPTION	Usage	No.	Length	Mat.	Qty
U904475G550	BOTPLATE	001	3488	0.75	1
U904475G550	NOGGING	002	158	0.75	2
U904475G550	HEAD	003	994	0.75	1
U904475G550	SILL	004	994	0.75	1
U904475G550	TOPPLATE	005	3329	0.75	1
U904475G550	NOGGING	006	2478	0.75	1
U904475G550	NOGGING	007	2478	0.75	1
U904475G550	TOPPLATE	008	489	0.75	1
C9075ra	STUD	100	3024	0.75	1
C9075ra	STUD	101	3066	0.75	1
C9075ra	STUD	102	3024	0.75	1
C9075ra	STUD	103	785	0.75	1
C9075ra	STUD	104	3024	0.75	1
C9075ra	STUD	105	3066	0.75	1
C9075ra	STUD	106	3024	0.75	6
C9075ra	STUD	107	3066	0.75	1
C9075ra	STUD	108	321	0.75	1
C9075ra	STUD	109	2974	0.75	1
BRA-1.0x30-550	Brace	201	3599	1.0	2
C9075ra	WEB	202	613	0.75	1
C9075ra	WEB	203	708	0.75	2
MULTIGRIP	TIEDOWN	N/A		3	2
Washer40x40x5	HOLDDOWN	N/A		5	4
TENSIONER_SET	Tensnr	N/A	0	N/A	2
SCREW-12-14x20-HEX	SCREW	N/A	-	-	8
SCREW-M6-1PX18-TEK	SCREW	N/A	-	-	16
WALLTITE	SCREW	N/A	-	-	144

Length crib: 2
Floor RL: 3217
INTERNAL wall

Screws at each end of BRA-1.0x30-550 = 3

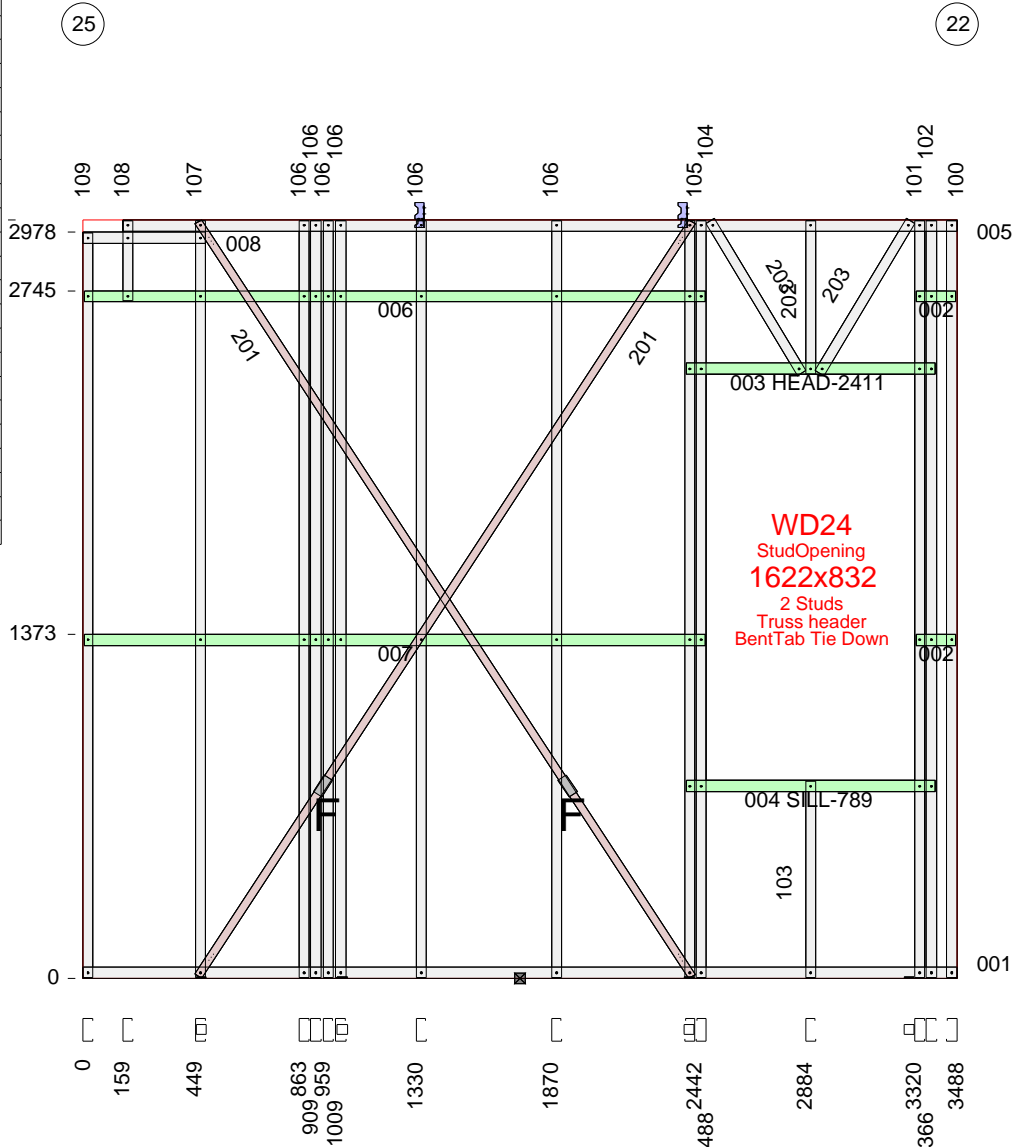

All dimensions to back of section. Where multiple lintels are used in place of a continuous lintel, it should have a minimum lap length of 450mm. Lintels should not be lapped over an opening.

ASSEMBLY DETAILS	OPENING DIMENSIONS (steel to steel)				PACKING DETAILS		LENGTH	MAX. HEIGHT
	ID	MANUF.	CAT NO.	UNIT DIM.	LEFT SIDE	RIGHT SIDE	3488	3028
ASSEMBLED:	W3	STUDOPEN	StudOpening	1622x832			DETAILER	DETAILED
FABRICATOR: TRUE STEEL FRAMES							VANTAGE_DS	21-10-2019
CUSTOMER: BERT FARINA CONSTRUCTION							WEIGHT	SCALE
CLIENT REF: 4 REDWOOD ST, ROSTREVOR							64	1:30

DESCRIPTION	Usage	No.	Length	Mat.	Qty
U904475G550	TOPPLATE	001	3328	0.75	1
U904475G550	BOTPLATE	002	3328	0.75	1
U904475G550	NOGGING	003	3318	0.75	2
C9075ra	STUD	100	3066	0.75	1
C9075ra	STUD	101	3024	0.75	6
C9075ra	STUD	102	3066	0.75	1
BRA-1.0x30-550	Brace	201	4473	1.0	2
MULTIGRIP	TIEDOWN	N/A		3	3
TENSIONER_SET	Tensnr	N/A	0	N/A	2
Washer40x40x5	HOLDDOWN	N/A		5	2
SCREW-12-14x20-HEX	SCREW	N/A	-	-	12
SCREW-M6-1PX18-TEK	SCREW	N/A	-	-	18
WALLTITE	SCREW	N/A	-	-	64

Length crib: 2
Floor RL: 3217
INTERNAL wall

Screws at each end of BRA-1.0x30-550 = 3

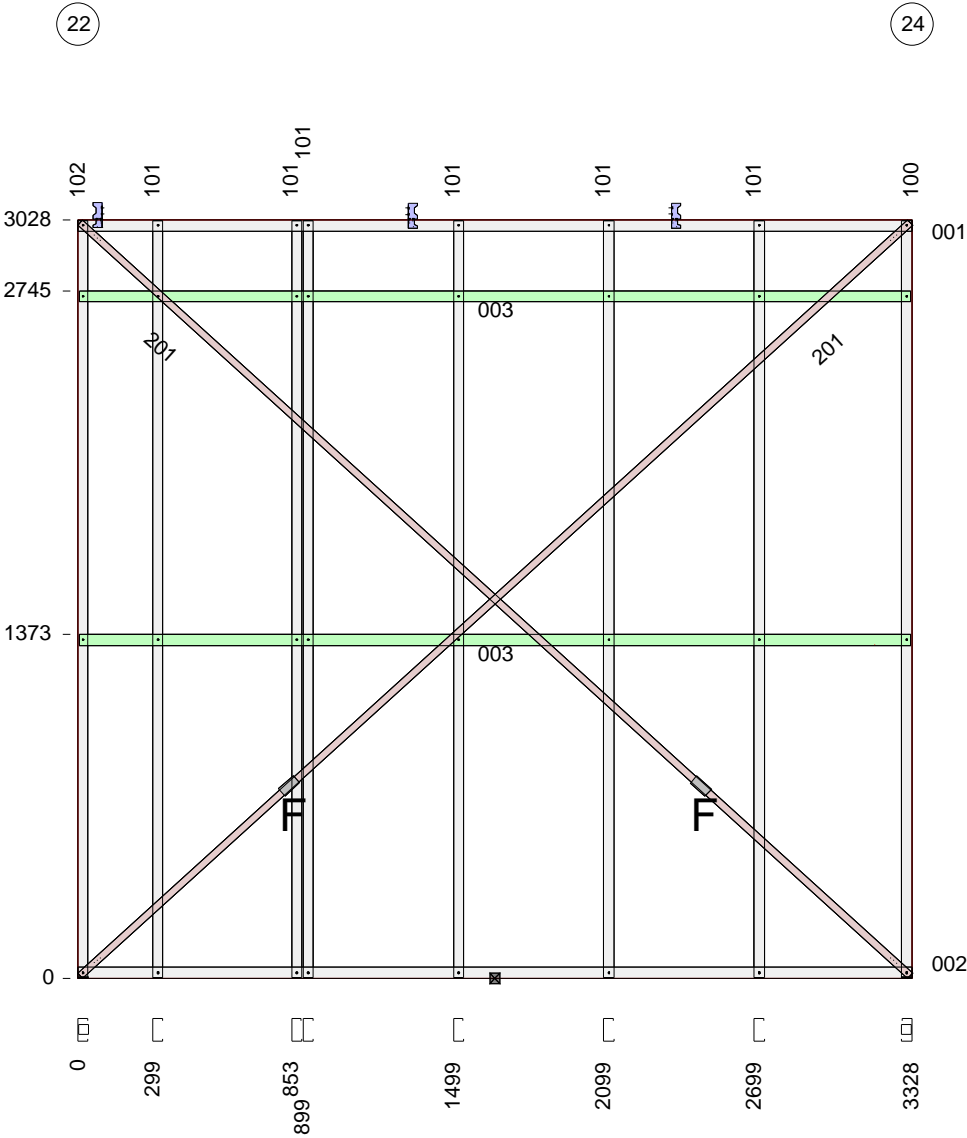

ASSEMBLY DETAILS	OPENING DIMENSIONS (steel to steel)					PACKING DETAILS		LENGTH	MAX. HEIGHT
	ID	HEIGHT	WIDTH	HEAD	SILL	LEFT SIDE	RIGHT SIDE	3328	3028
ASSEMBLED: FABRICATOR: TRUE STEEL FRAMES CUSTOMER: BERT FARINA CONSTRUCTION CLIENT REF: 4 REDWOOD ST, ROSTREVOR								DETAILER	DETAILED
								VANTAGE_DS	21-10-2019
								WEIGHT	SCALE
								43	1:30

DESCRIPTION	Usage	No.	Length	Mat.	Qty
U904475G550	TOPPLATE	001	3398	0.75	1
U904475G550	BOTPLATE	002	3398	0.75	1
U904475G550	NOGGING	003	753	0.75	1
U904475G550	HEAD	004	794	0.75	1
U904475G550	NOGGING	005	1993	0.75	1
C9075ra	STUD	100	2741	0.75	1
C9075ra	STUD	101	2741	0.75	6
C9075ra	STUD	102	2741	0.75	1
C9075ra	STUD	103	2783	0.75	1
C9075ra	STUD	104	2741	0.75	1
C9075ra	STUD	105	2783	0.75	1
C9075ra	STUD	106	2783	0.75	1
BRA-1.0x30-550	Brace	201	3345	1.0	2
C9075ra	WEB	202	330	0.75	1
C9075ra	WEB	203	419	0.75	2
MULTIGRIP	TIEDOWN	N/A		3	3
Washer40x40x5	HOLDDOWN	N/A		5	3
TENSIONER_SET	Tensnr	N/A	0	N/A	2
SCREW-12-14x20-HEX	SCREW	N/A	-	-	12
SCREW-M6-1PX18-TEK	SCREW	N/A	-	-	18
WALLTITE	SCREW	N/A	-	-	92

Length crib: 2
Floor RL: 3217
INTERNAL wall

Screws at each end of BRA-1.0x30-550 = 3

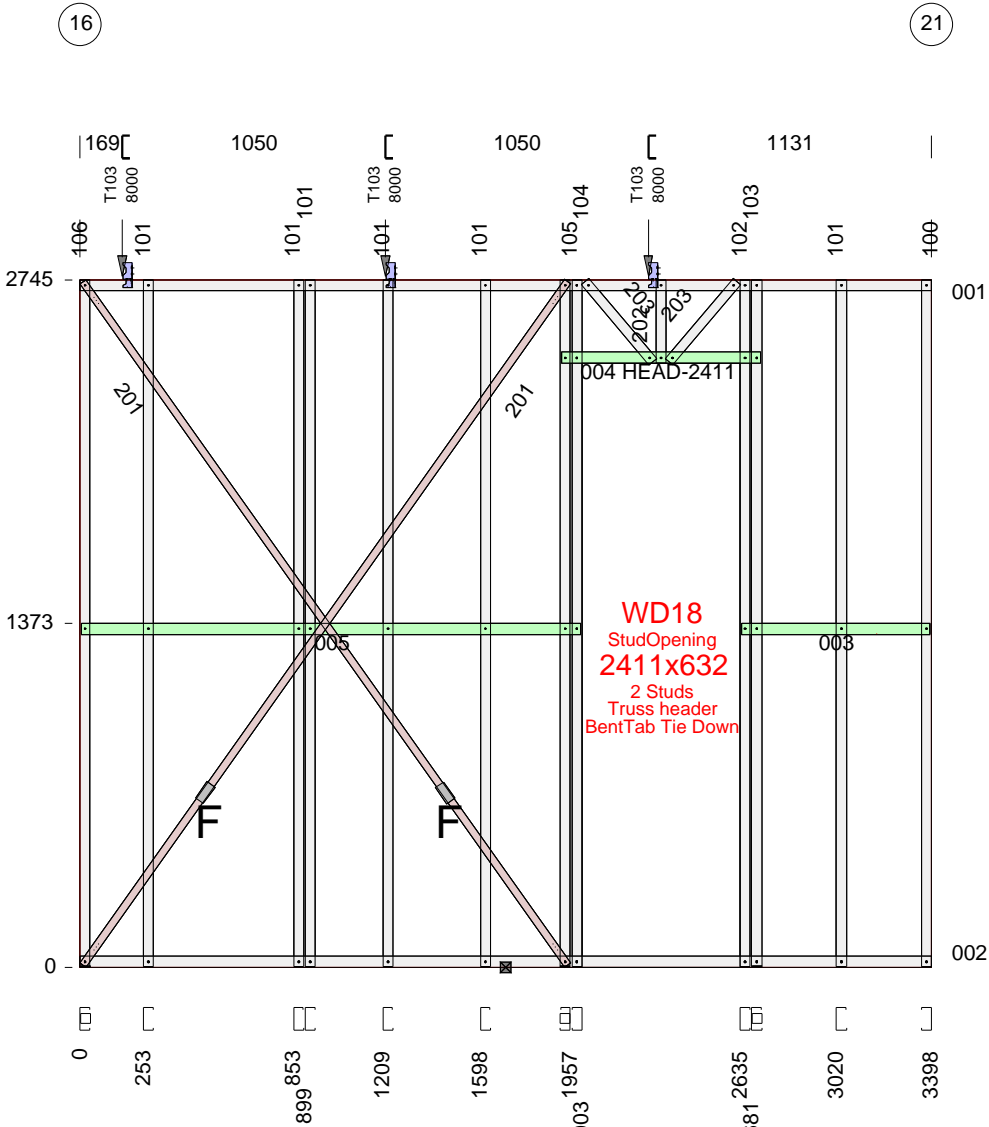

All dimensions to back of section. Where multiple lintels are used in place of a continuous lintel, it should have a minimum lap length of 450mm. Lintels should not be lapped over an opening.

ASSEMBLY DETAILS	OPENING DIMENSIONS (steel to steel)				PACKING DETAILS		LENGTH	MAX. HEIGHT
	ID	MANUF.	CAT NO.	UNIT DIM.	LEFT SIDE	RIGHT SIDE	3398	2745
ASSEMBLED:	D1	STUDOPEN	StudOpening	2411x632			DETAILER	DETAILED
FABRICATOR: TRUE STEEL FRAMES							VANTAGE_DS	21-10-2019
CUSTOMER: BERT FARINA CONSTRUCTION							WEIGHT	SCALE
CLIENT REF: 4 REDWOOD ST, ROSTREVOR							50	1:30

DESCRIPTION	Usage	No.	Length	Mat.	Qty
U904475G550	TOPPLATE	001	2684	0.75	1
U904475G550	BOTPLATE	002	2488	0.75	1
U904475G550	NOGGING	003	2478	0.75	2
C9075ra	STUD	100	4153	0.75	1
C9075ra	STUD	101	3868	0.75	1
C9075ra	STUD	102	3626	0.75	1
C9075ra	STUD	103	3391	0.75	1
C9075ra	STUD	104	3199	0.75	1
C9075ra	STUD	105	3121	0.75	1
BRA-1.0x30-550	Brace	201	4743	1.0	1
BRA-1.0x30-550	Brace	202	3946	1.0	1
TENSIONER_SET	Tensnr	N/A	0		2
Washer40x40x5	HOLDDOWN	N/A		5	2
SCREW-M6-1PX18-TEK	SCREW	N/A	-	-	12
WALLTITE	SCREW	N/A	-	-	48

Length crib: 2
Floor RL: 3217
INTERNAL wall

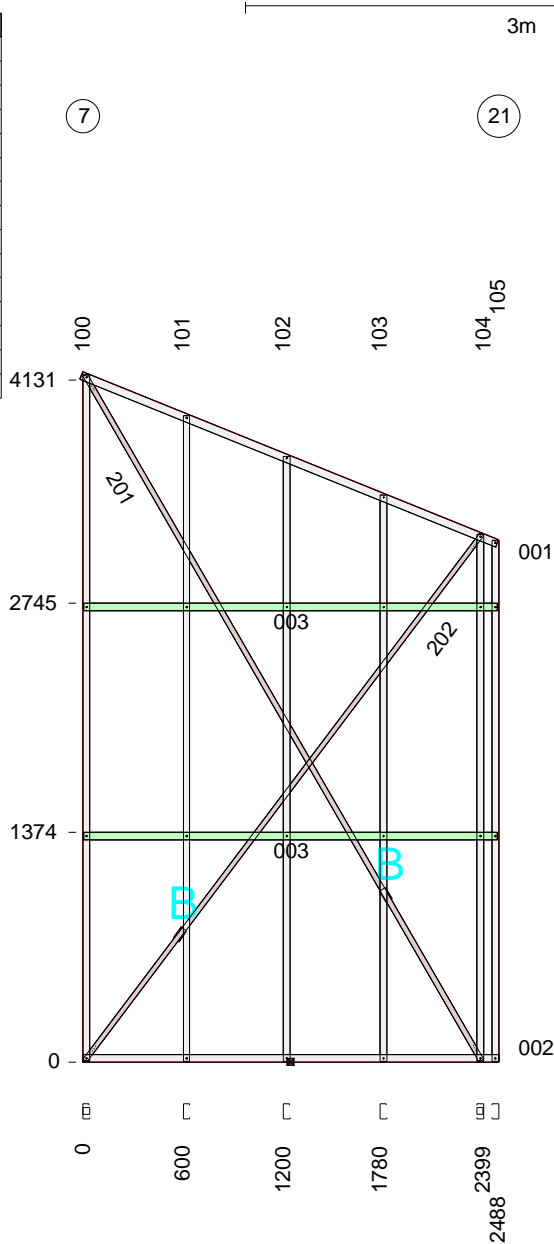

Screws at each end of BRA-1.0x30-550 = 3

All dimensions to back of section. Where multiple lintels are used in place of a continuous lintel, it should have a minimum lap length of 450mm. Lintels should not be lapped over an opening.

ASSEMBLY DETAILS	OPENING DIMENSIONS (steel to steel)					PACKING DETAILS		LENGTH	MAX. HEIGHT
	ID	HEIGHT	WIDTH	HEAD	SILL	LEFT SIDE	RIGHT SIDE	2488	4131
ASSEMBLED: FABRICATOR: TRUE STEEL FRAMES CUSTOMER: BERT FARINA CONSTRUCTION CLIENT REF: 4 REDWOOD ST, ROSTREVOR								DETAILER	DETAILED
								VANTAGE_DS	21-10-2019
								WEIGHT	SCALE
								36	1:45

DESCRIPTION	Usage	No.	Length	Mat.	Qty
U904475G550	BOTPLATE	001	2398	0.75	1
U904475G550	TOPPLATE	002	873	0.75	1
U904475G550	NOGGING	003	1188	0.75	1
U904475G550	NOGGING	004	2388	0.75	2
U904475G550	TOPPLATE	005	1714	0.75	1
C9075ra	STUD	100	4127	0.75	1
C9075ra	STUD	101	4361	0.75	1
C9075ra	STUD	102	4297	0.75	1
C9075ra	STUD	103	4054	0.75	1
C9075ra	STUD	104	3812	0.75	1
WALLTITE	SCREW	N/A	-	-	46

Length crib: 2
Floor RL: 3217
INTERNAL wall

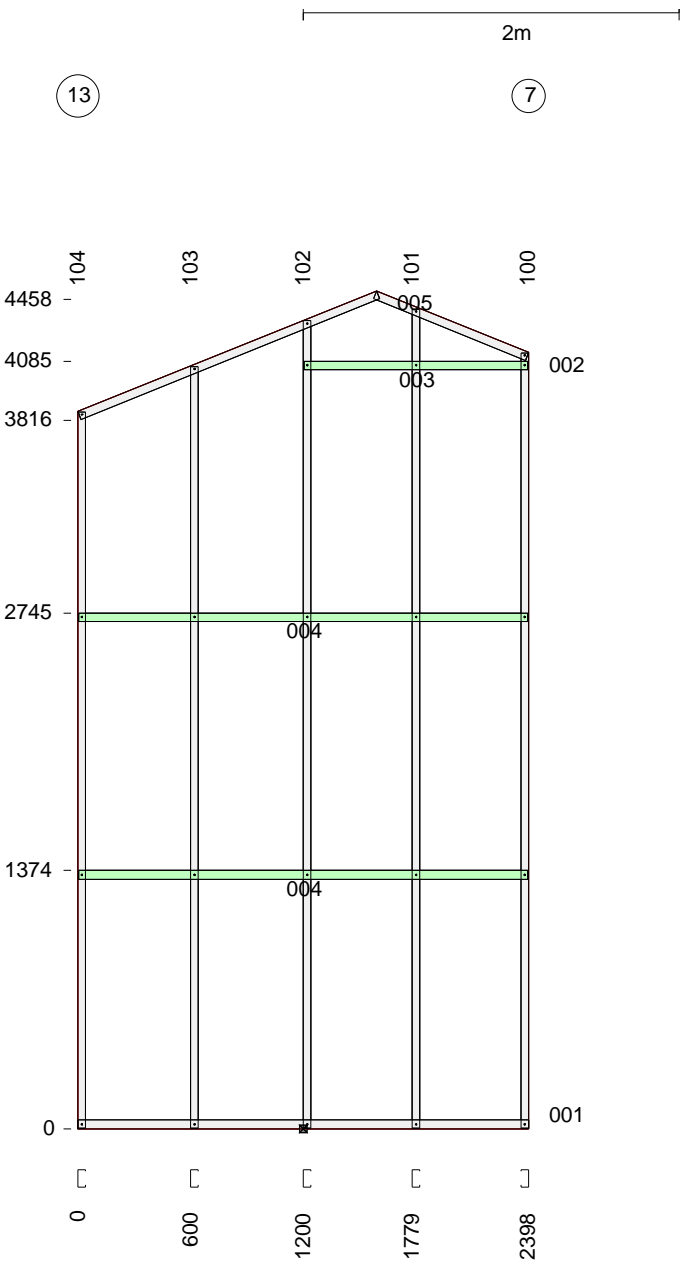

All dimensions to back of section. Where multiple lintels are used in place of a continuous lintel, it should have a minimum lap length of 450mm. Lintels should not be lapped over an opening.

ASSEMBLY DETAILS	OPENING DIMENSIONS (steel to steel)					PACKING DETAILS		LENGTH	MAX. HEIGHT
	ID	HEIGHT	WIDTH	HEAD	SILL	LEFT SIDE	RIGHT SIDE	2398	4458
ASSEMBLED: FABRICATOR: TRUE STEEL FRAMES CUSTOMER: BERT FARINA CONSTRUCTION CLIENT REF: 4 REDWOOD ST, ROSTREVOR								DETAILER	DETAILED
								VANTAGE_DS	21-10-2019
								WEIGHT	SCALE
								34	1:40

DESCRIPTION	Usage	No.	Length	Mat.	Qty
U904475G550	TOPPLATE	001	2209	0.75	1
U904475G550	BOTPLATE	002	2048	0.75	1
U904475G550	NOGGING	003	2038	0.75	2
C9075ra	STUD	100	2984	0.75	1
C9075ra	STUD	101	3062	0.75	1
C9075ra	STUD	102	3262	0.75	1
C9075ra	STUD	103	3505	0.75	1
C9075ra	STUD	104	3650	0.75	1
C9075ra	STUD	105	3838	0.75	1
BRA-1.0x30-550	Brace	201	4255	1.0	1
BRA-1.0x30-550	Brace	202	3581	1.0	1
TENSIONER_SET	Tensnr	N/A	0	N/A	2
Washer40x40x5	HOLDDOWN	N/A		5	2
SCREW-M6-1PX18-TEK	SCREW	N/A	-	-	12
WALLTITE	SCREW	N/A	-	-	48

Length crib: 2
Floor RL: 3217
INTERNAL wall

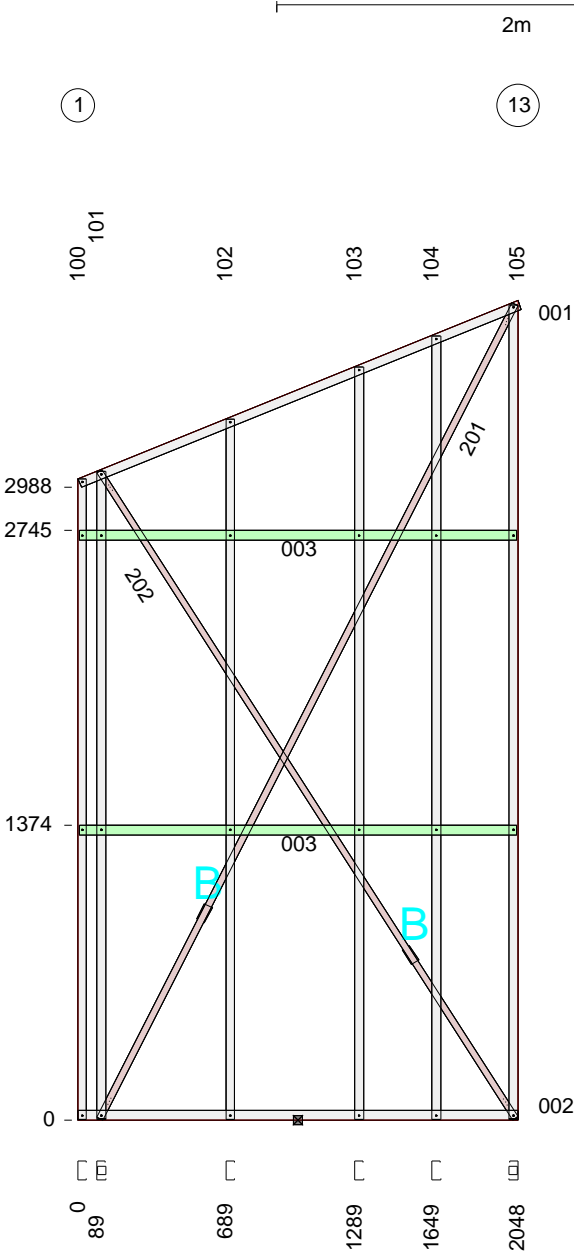

All dimensions to back of section. Where multiple lintels are used in place of a continuous lintel, it should have a minimum lap length of 450mm. Lintels should not be lapped over an opening.

ASSEMBLY DETAILS	OPENING DIMENSIONS (steel to steel)					PACKING DETAILS		LENGTH	MAX. HEIGHT
	ID	HEIGHT	WIDTH	HEAD	SILL	LEFT SIDE	RIGHT SIDE	2048	3816
ASSEMBLED: FABRICATOR: TRUE STEEL FRAMES CUSTOMER: BERT FARINA CONSTRUCTION CLIENT REF: 4 REDWOOD ST, ROSTREVOR								DETAILER	DETAILED
								VANTAGE_DS	21-10-2019
								WEIGHT	SCALE
								33	1:35

DESCRIPTION	Usage	No.	Length	Mat.	Qty
U904475G550	TOPPLATE	001	548	0.75	1
U904475G550	BOTPLATE	002	548	0.75	1
U904475G550	NOGGING	003	538	0.75	1
C9075ra	STUD	100	2741	0.75	1
C9075ra	STUD	101	2741	0.75	1
WALLTITE	SCREW	N/A	-	-	12

Length crib: 2
Floor RL: 3217
INTERNAL wall

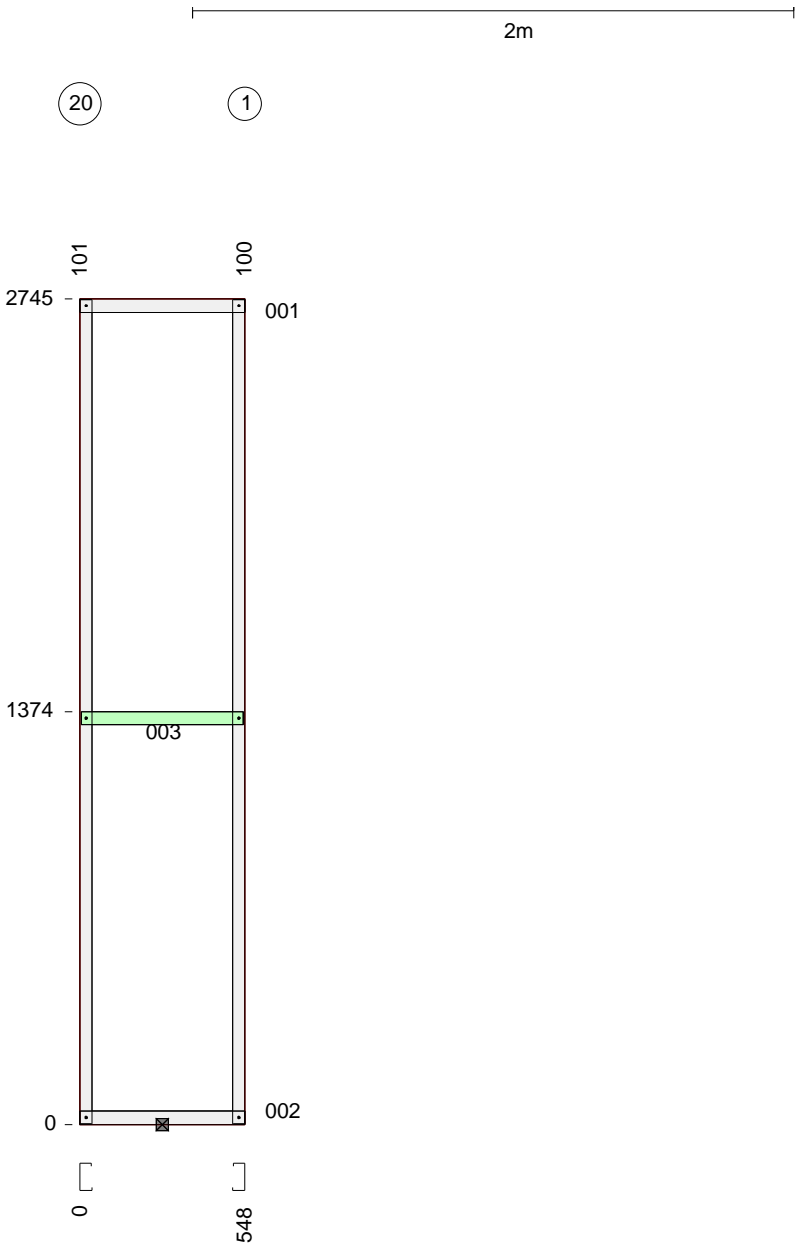

All dimensions to back of section. Where multiple lintels are used in place of a continuous lintel, it should have a minimum lap length of 450mm. Lintels should not be lapped over an opening.

ASSEMBLY DETAILS	OPENING DIMENSIONS (steel to steel)					PACKING DETAILS		LENGTH	MAX. HEIGHT
	ID	HEIGHT	WIDTH	HEAD	SILL	LEFT SIDE	RIGHT SIDE	548	2745
ASSEMBLED:								DETAILER	DETAILED
FABRICATOR: TRUE STEEL FRAMES								VANTAGE_DS	21-10-2019
CUSTOMER: BERT FARINA CONSTRUCTION								WEIGHT	SCALE
CLIENT REF: 4 REDWOOD ST, ROSTREVOR								8	1:25

DESCRIPTION	Usage	No.	Length	Mat.	Qty
U904475G550	TOPPLATE	001	928	0.75	1
U904475G550	BOTPLATE	002	928	0.75	1
U904475G550	NOGGING	003	918	0.75	1
C9075ra	STUD	100	2783	0.75	1
C9075ra	STUD	101	2741	0.75	1
C9075ra	STUD	102	2783	0.75	1
BRA-1.0x30-550	Brace	201	2877	1.0	2
TENSIONER_SET	Tensnr	N/A	0	N/A	2
Washer40x40x5	HOLDDOWN	N/A		5	2
SCREW-M6-1PX18-TEK	SCREW	N/A	-	-	12
WALLTITE	SCREW	N/A	-	-	18

Length crib: 2
Floor RL: 3217
INTERNAL wall

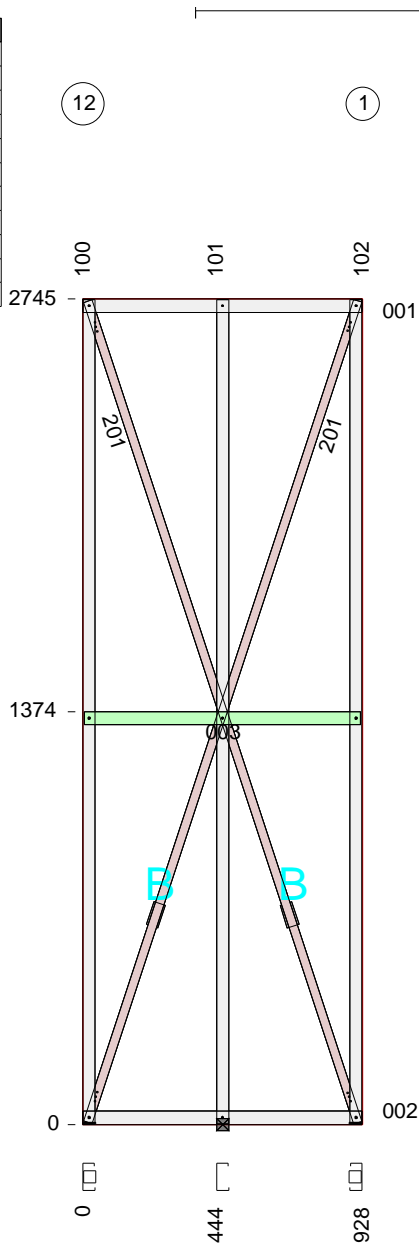

Screws at each end of BRA-1.0x30-550 = 3

All dimensions to back of section. Where multiple lintels are used in place of a continuous lintel, it should have a minimum lap length of 450mm. Lintels should not be lapped over an opening.

ASSEMBLY DETAILS	OPENING DIMENSIONS (steel to steel)					PACKING DETAILS		LENGTH	MAX. HEIGHT
	ID	HEIGHT	WIDTH	HEAD	SILL	LEFT SIDE	RIGHT SIDE	928	2745
ASSEMBLED:								DETAILER	DETAILED
FABRICATOR: TRUE STEEL FRAMES								VANTAGE_DS	21-10-2019
CUSTOMER: BERT FARINA CONSTRUCTION								WEIGHT	SCALE
CLIENT REF: 4 REDWOOD ST, ROSTREVOR								14	1:25

DESCRIPTION	Usage	No.	Length	Mat.	Qty
U904475G550	TOPPLATE	001	398	0.75	1
U904475G550	BOTPLATE	002	398	0.75	1
U904475G550	NOGGING	003	388	0.75	2
C9075ra	STUD	100	3141	0.75	1
C9075ra	STUD	101	3141	0.75	2
WALLTITE	SCREW	N/A	-	-	24

Length crib: 2
Floor RL: 3217
INTERNAL wall

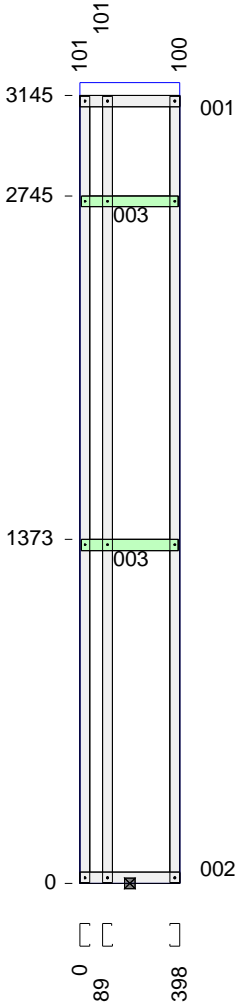

All dimensions to back of section. Where multiple lintels are used in place of a continuous lintel, it should have a minimum lap length of 450mm. Lintels should not be lapped over an opening.

ASSEMBLY DETAILS	OPENING DIMENSIONS (steel to steel)					PACKING DETAILS		LENGTH	MAX. HEIGHT
	ID	HEIGHT	WIDTH	HEAD	SILL	LEFT SIDE	RIGHT SIDE	398	3195
ASSEMBLED:								DETAILER	DETAILED
FABRICATOR: TRUE STEEL FRAMES								VANTAGE_DS	21-10-2019
CUSTOMER: BERT FARINA CONSTRUCTION								WEIGHT	SCALE
CLIENT REF: 4 REDWOOD ST, ROSTREVOR								12	1:30

DESCRIPTION	Usage	No.	Length	Mat.	Qty
U904475G550	TOPPLATE	001	3003	0.75	1
U904475G550	BOTPLATE	002	3003	0.75	1
U904475G550	NOGGING	003	1898	0.75	2
U904475G550	HEAD	004	1059	0.75	1
U904475G550	NOGGING	005	188	0.75	2
C9075ra	STUD	100	3233	0.75	1
C9075ra	STUD	101	3191	0.75	5
C9075ra	STUD	102	3191	0.75	1
C9075ra	STUD	103	3233	0.75	1
C9075ra	STUD	104	780	0.75	3
C9075ra	STUD	105	3191	0.75	1
C9075ra	STUD	106	3233	0.75	1
C9075ra	STUD	107	3191	0.75	1
BRA-1.0x30-550	Brace	201	3673	1.0	2
C9055ra	WEB	202	831	0.55	1
C9055ra	WEB	203	816	0.55	1
C9055ra	WEB	204	787	0.55	1
Washer40x40x5	HOLDDOWN	N/A		5	3
TENSIONER_SET	Tensnr	N/A	0	N/A	2
SCREW-M6-1PX18-TEK	SCREW	N/A	-	-	12
WALLTITE	SCREW	N/A	-	-	120

Length crib: 2
Floor RL: 3217
INTERNAL wall

Screws at each end of BRA-1.0x30-550 = 3

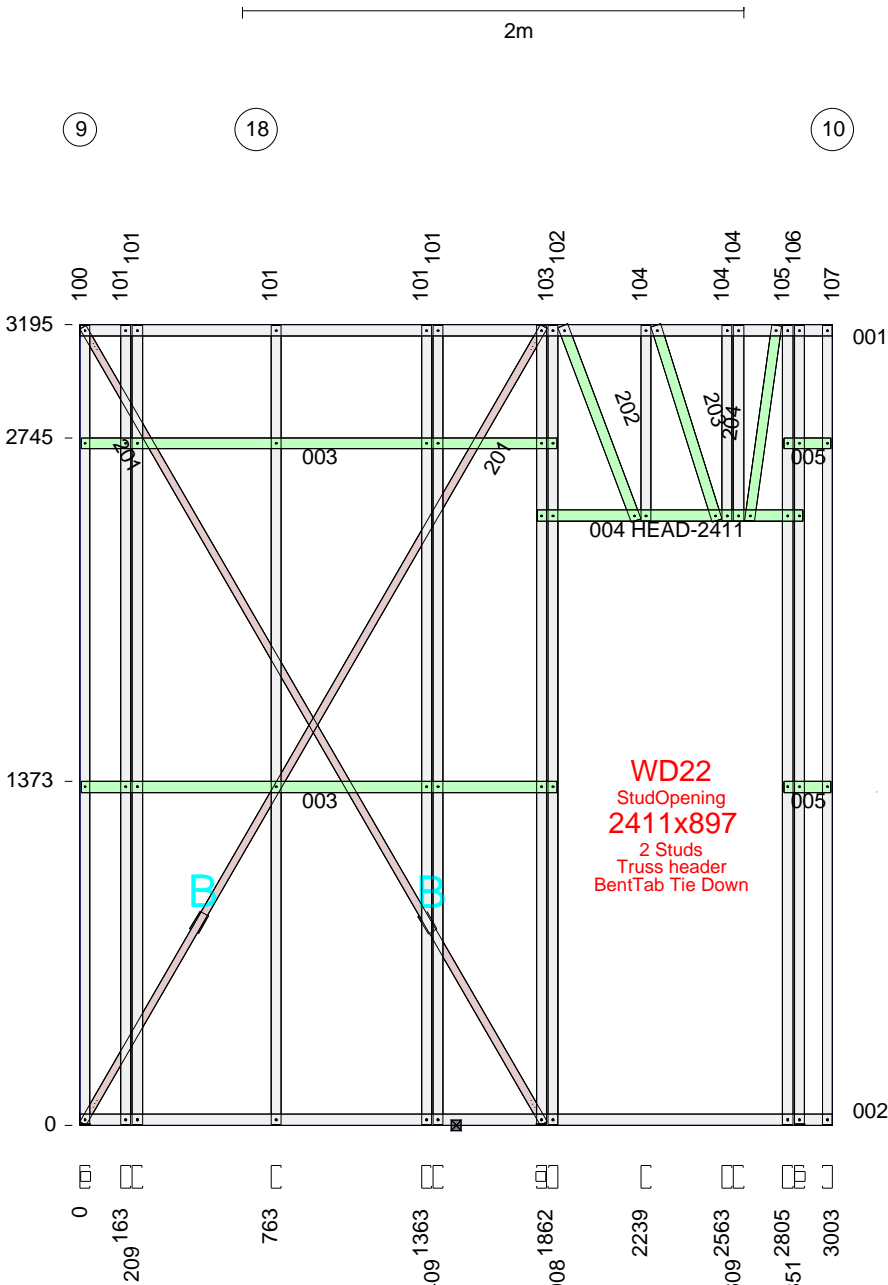

All dimensions to back of section. Where multiple lintels are used in place of a continuous lintel, it should have a minimum lap length of 450mm. Lintels should not be lapped over an opening.

ASSEMBLY DETAILS	OPENING DIMENSIONS (steel to steel)				PACKING DETAILS		LENGTH	MAX. HEIGHT
	ID	MANUF.	CAT NO.	UNIT DIM.	LEFT SIDE	RIGHT SIDE	3003	3195
ASSEMBLED:	D4	STUDOPEN	StudOpening	2411x897			DETAILER	DETAILED
FABRICATOR: TRUE STEEL FRAMES							VANTAGE_DS	21-10-2019
CUSTOMER: BERT FARINA CONSTRUCTION							WEIGHT	SCALE
CLIENT REF: 4 REDWOOD ST, ROSTREVOR							57	1:30

DESCRIPTION	Usage	No.	Length	Mat.	Qty
U904475G550	TOPPLATE	001	398	0.75	1
U904475G550	BOTPLATE	002	398	0.75	1
U904475G550	NOGGING	003	388	0.75	2
C9075ra	STUD	100	3141	0.75	1
C9075ra	STUD	101	3141	0.75	2
WALLTITE	SCREW	N/A	-	-	24

Length crib: 2
Floor RL: 3217
INTERNAL wall

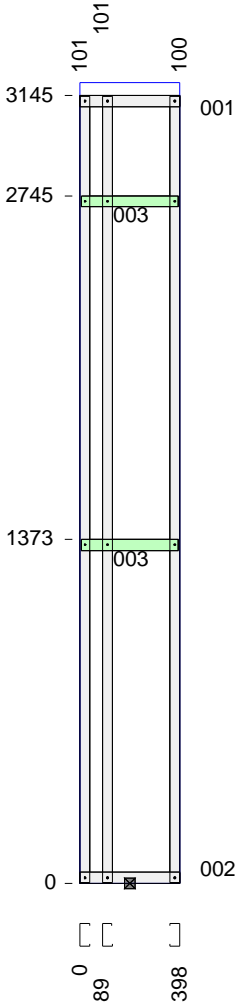

All dimensions to back of section. Where multiple lintels are used in place of a continuous lintel, it should have a minimum lap length of 450mm. Lintels should not be lapped over an opening.

ASSEMBLY DETAILS	OPENING DIMENSIONS (steel to steel)					PACKING DETAILS		LENGTH	MAX. HEIGHT
	ID	HEIGHT	WIDTH	HEAD	SILL	LEFT SIDE	RIGHT SIDE	398	3195
ASSEMBLED:								DETAILER	DETAILED
FABRICATOR: TRUE STEEL FRAMES								VANTAGE_DS	21-10-2019
CUSTOMER: BERT FARINA CONSTRUCTION								WEIGHT	SCALE
CLIENT REF: 4 REDWOOD ST, ROSTREVOR								12	1:30

DESCRIPTION	Usage	No.	Length	Mat.	Qty
U904475G550	TOPPLATE	001	3328	0.75	1
U904475G550	BOTPLATE	002	3328	0.75	1
U904475G550	NOGGING	003	2319	0.75	1
U904475G550	HEAD	004	980	0.75	1
U904475G550	NOGGING	005	79	0.75	1
C9075ra	STUD	100	2748	0.75	1
C9055ra	STUD	101	2706	0.55	4
C9075ra	STUD	102	2748	0.75	1
C9075ra	STUD	103	2706	0.75	1
C9075ra	STUD	104	296	0.75	1
C9075ra	STUD	105	2706	0.75	1
BRA-1.0x30-550	Brace	201	3464	1.0	2
TENSIONER_SET	Tensnr	N/A	0	N/A	2
Washer40x40x5	HOLDDOWN	N/A	-	5	2
SCREW-M6-1PX18-TEK	SCREW	N/A	-	-	12
WALLTITE	SCREW	N/A	-	-	56

Length crib: 2
Floor RL: 3217
INTERNAL wall

Screws at each end of BRA-1.0x30-550 = 3

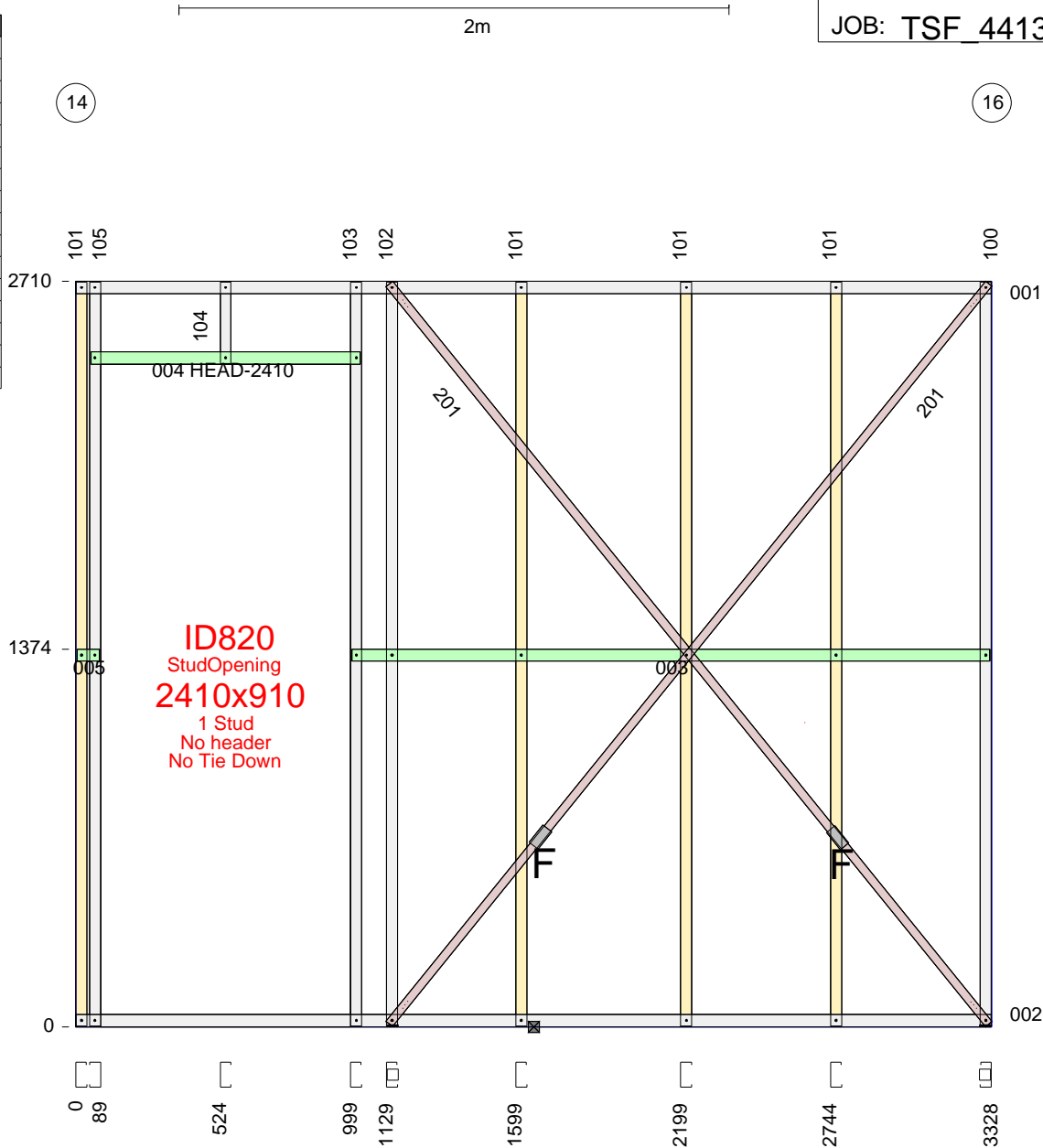

All dimensions to back of section. Where multiple lintels are used in place of a continuous lintel, it should have a minimum lap length of 450mm. Lintels should not be lapped over an opening.

ASSEMBLY DETAILS	OPENING DIMENSIONS (steel to steel)				PACKING DETAILS		LENGTH	MAX. HEIGHT
	ID	MANUF.	CAT NO.	UNIT DIM.	LEFT SIDE	RIGHT SIDE	3328	2710
ASSEMBLED:	D9	STUDOPEN	StudOpening	2410x910			DETAILER	DETAILED
FABRICATOR: TRUE STEEL FRAMES							VANTAGE_DS	21-10-2019
CUSTOMER: BERT FARINA CONSTRUCTION							WEIGHT	SCALE
CLIENT REF: 4 REDWOOD ST, ROSTREVOR							33	1:25

DESCRIPTION	Usage	No.	Length	Mat.	Qty
U904475G550	TOPPLATE	001	3808	0.75	1
U904475G550	BOTPLATE	002	3808	0.75	1
U904475G550	NOGGING	003	2269	0.75	1
U904475G550	HEAD	004	972	0.75	1
U904475G550	NOGGING	005	709	0.75	1
C9075ra	STUD	100	2783	0.75	1
C9075ra	STUD	101	2741	0.75	6
C9075ra	STUD	102	2741	0.75	1
C9075ra	STUD	103	2783	0.75	1
C9075ra	STUD	104	2741	0.75	1
C9075ra	STUD	105	2783	0.75	1
C9075ra	STUD	106	2783	0.75	1
BRA-1.0x30-550	Brace	201	3512	1.0	2
BRA-1.0x30-550	Brace	202	2808	1.0	2
C9075ra	WEB	203	331	0.75	1
C9075ra	WEB	204	482	0.75	2
C9075ra	STIFFENER	300	302	0.75	1
TRANSITION_PART_90	TIEDOWN	N/A		1	3
TENSIONER_SET	Tensnr	N/A	0	N/A	4
Washer40x40x5	HOLDDOWN	N/A		5	4
SCREW-12-14x20-HEX	SCREW	N/A	-	-	12
SCREW-M6-1PX18-TEK	SCREW	N/A	-	-	30
WALLTITE	SCREW	N/A	-	-	98

Length crib: 2
Floor RL: 3217
INTERNAL wall

Screws at each end of BRA-1.0x30-550 = 3

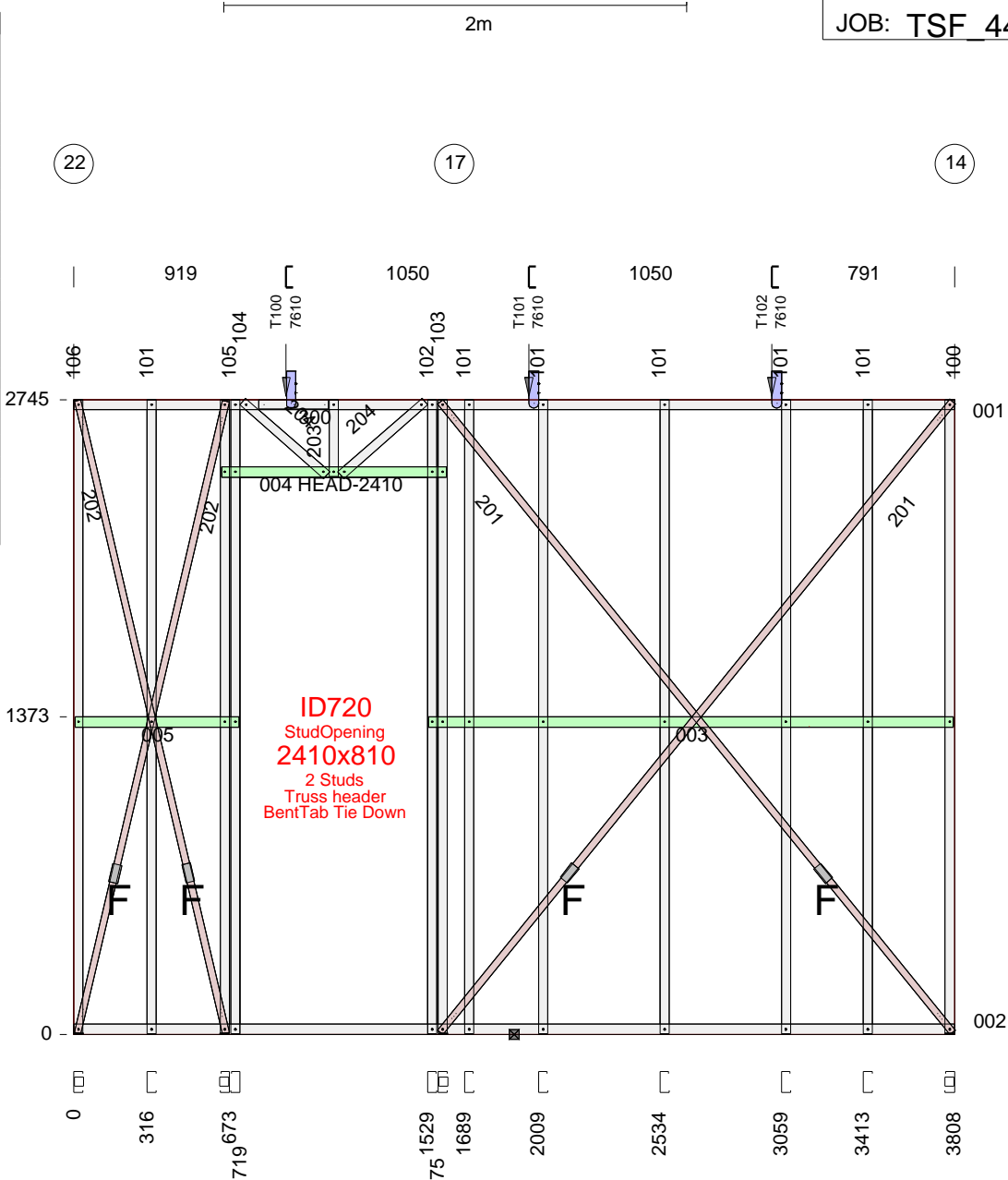

All dimensions to back of section. Where multiple lintels are used in place of a continuous lintel, it should have a minimum lap length of 450mm. Lintels should not be lapped over an opening.

ASSEMBLY DETAILS	OPENING DIMENSIONS (steel to steel)				PACKING DETAILS		LENGTH	MAX. HEIGHT
	ID	MANUF.	CAT NO.	UNIT DIM.	LEFT SIDE	RIGHT SIDE	3808	2745
ASSEMBLED:	D7	STUDOPEN	StudOpening	2410x810			DETAILER	DETAILED
FABRICATOR: TRUE STEEL FRAMES							VANTAGE_DS	21-10-2019
CUSTOMER: BERT FARINA CONSTRUCTION							WEIGHT	SCALE
CLIENT REF: 4 REDWOOD ST, ROSTREVOR							53	1:30

DESCRIPTION	Usage	No.	Length	Mat.	Qty
U904475G550	TOPPLATE	001	2468	0.75	1
U904475G550	BOTPLATE	002	2468	0.75	1
U904475G550	NOGGING	003	409	0.75	1
U904475G550	HEAD	004	1072	0.75	1
U904475G550	NOGGING	005	1129	0.75	1
C9075ra	STUD	100	2741	0.75	1
C9075ra	STUD	101	2741	0.75	1
C9075ra	STUD	102	2783	0.75	1
C9075ra	STUD	103	2741	0.75	1
C9075ra	STUD	104	2783	0.75	1
C9075ra	STUD	105	2741	0.75	4
C9075ra	WEB	201	331	0.75	1
C9075ra	WEB	202	521	0.75	2
C9075ra	STIFFENER	300	346	0.75	1
MULTIGRIP	TIEDOWN	N/A		3	3
Washer40x40x5	HOLDDOWN	N/A		5	2
SCREW-12-14x20-HEX	SCREW	N/A	-	-	12
SCREW-M6-1PX18-TEK	SCREW	N/A	-	-	6
WALLTITE	SCREW	N/A	-	-	80

Length crib: 2
Floor RL: 3217
INTERNAL wall

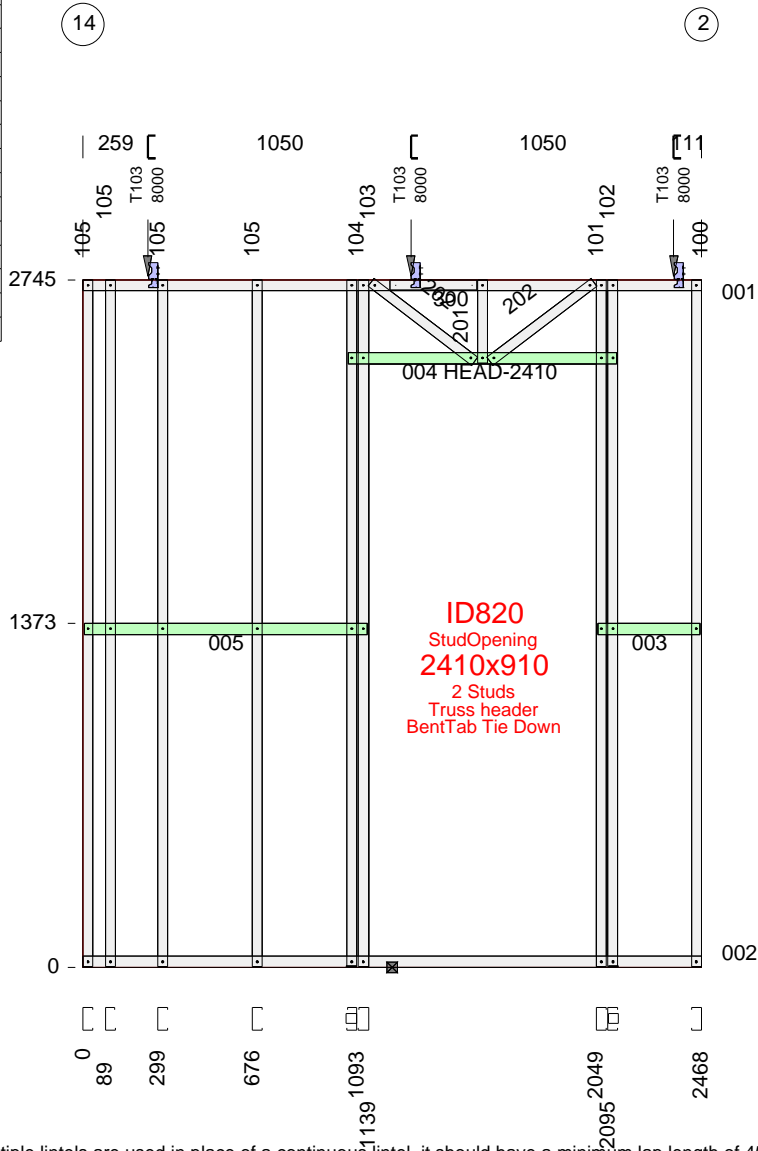

All dimensions to back of section. Where multiple lintels are used in place of a continuous lintel, it should have a minimum lap length of 450mm. Lintels should not be lapped over an opening.

ASSEMBLY DETAILS	OPENING DIMENSIONS (steel to steel)				PACKING DETAILS		LENGTH	MAX. HEIGHT
	ID	MANUF.	CAT NO.	UNIT DIM.	LEFT SIDE	RIGHT SIDE	2468	2745
ASSEMBLED:	D6	STUDOPEN	StudOpening	2410x910			DETAILER	DETAILED
FABRICATOR: TRUE STEEL FRAMES							VANTAGE_DS	21-10-2019
CUSTOMER: BERT FARINA CONSTRUCTION							WEIGHT	SCALE
CLIENT REF: 4 REDWOOD ST, ROSTREVOR							37	1:30

DESCRIPTION	Usage	No.	Length	Mat.	Qty
U904475G550	TOPPLATE	001	3718	0.75	1
U904475G550	BOTPLATE	002	3718	0.75	1
U904475G550	NOGGING	003	3708	0.75	1
C9055ra	STUD	100	2706	0.55	6
C9075ra	STUD	101	2748	0.75	2
C9055ra	STUD	102	2706	0.55	2
BRA-1.0x30-550	Brace	201	3622	1.0	2
TENSIONER_SET	Tensnr	N/A	0	N/A	2
Washer40x40x5	HOLDDOWN	N/A		5	2
SCREW-M6-1PX18-TEK	SCREW	N/A	-	-	12
WALLTITE	SCREW	N/A	-	-	60

Length crib: 2
Floor RL: 3217
INTERNAL wall

Screws at each end of BRA-1.0x30-550 = 3

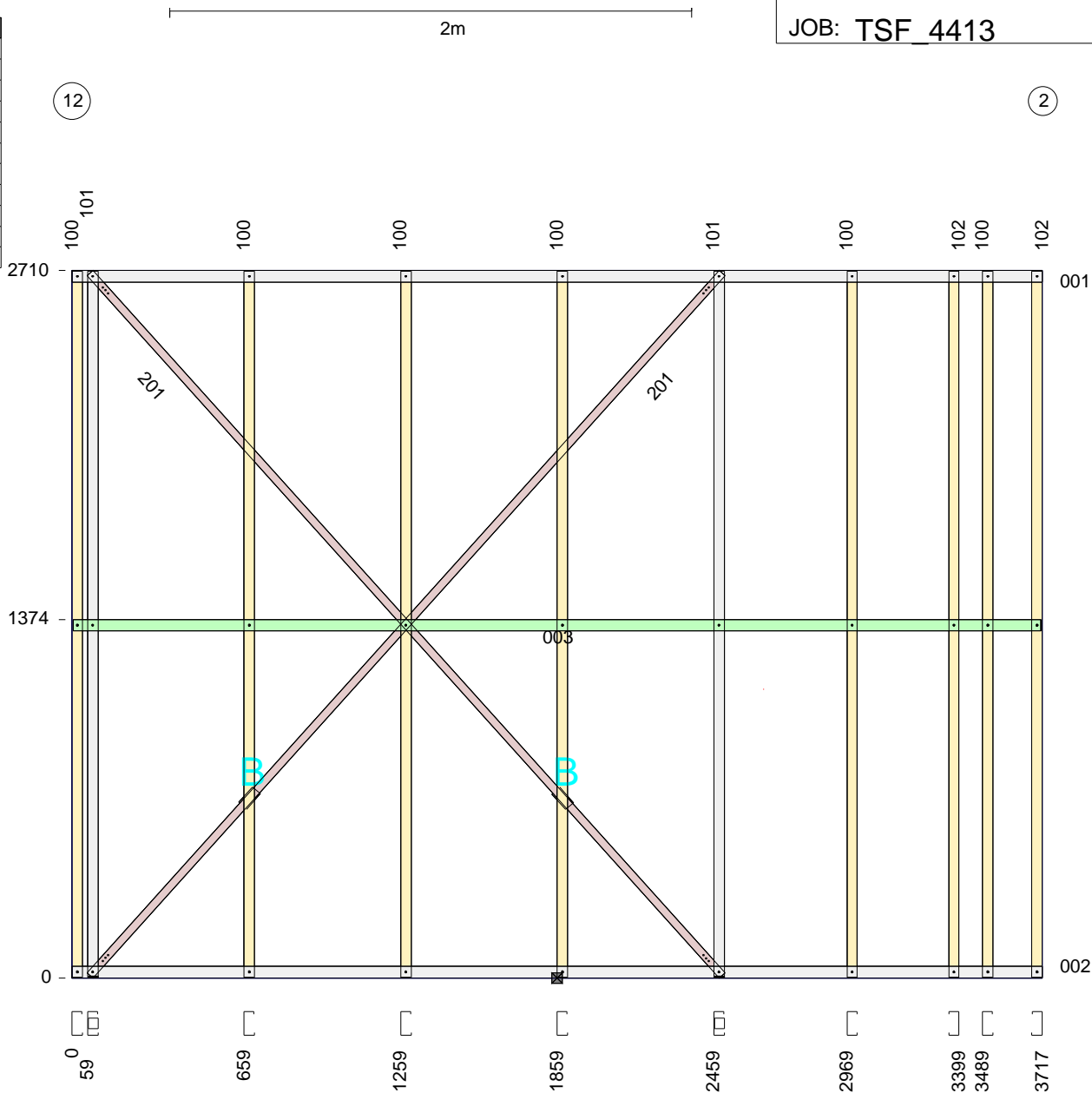

All dimensions to back of section. Where multiple lintels are used in place of a continuous lintel, it should have a minimum lap length of 450mm. Lintels should not be lapped over an opening.

ASSEMBLY DETAILS	OPENING DIMENSIONS (steel to steel)					PACKING DETAILS		LENGTH	MAX. HEIGHT
	ID	HEIGHT	WIDTH	HEAD	SILL	LEFT SIDE	RIGHT SIDE	3717	2710
ASSEMBLED:								DETAILER	DETAILED
FABRICATOR: TRUE STEEL FRAMES								VANTAGE_DS	21-10-2019
CUSTOMER: BERT FARINA CONSTRUCTION								WEIGHT	SCALE
CLIENT REF: 4 REDWOOD ST, ROSTREVOR								37	1:25

DESCRIPTION	Usage	No.	Length	Mat.	Qty
U904475G550	TOPPLATE	001	1198	0.75	1
U904475G550	BOTPLATE	002	1198	0.75	1
U904475G550	NOGGING	003	1188	0.75	1
C9075ra	STUD	100	2748	0.75	1
C9055ra	STUD	101	2706	0.55	1
C9075ra	STUD	102	2748	0.75	1
BRA-1.0x30-550	Brace	201	2940	1.0	2
TENSIONER_SET	Tensnr	N/A	0	N/A	2
Washer40x40x5	HOLDDOWN	N/A		5	2
SCREW-M6-1PX18-TEK	SCREW	N/A	-	-	12
WALLTITE	SCREW	N/A	-	-	18

Length crib: 2
Floor RL: 3217
INTERNAL wall

Screws at each end of BRA-1.0x30-550 = 3

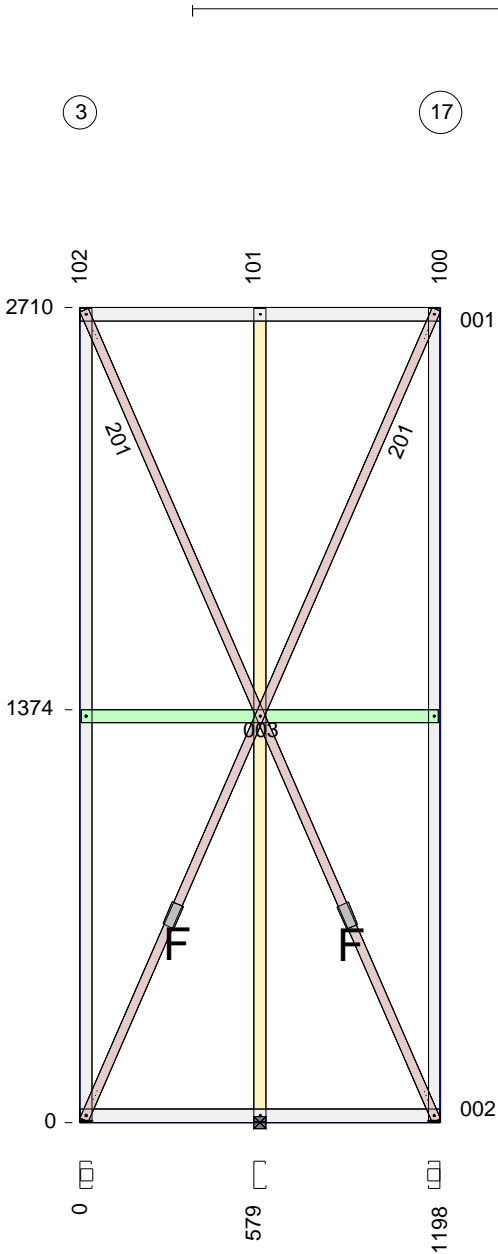

All dimensions to back of section. Where multiple lintels are used in place of a continuous lintel, it should have a minimum lap length of 450mm. Lintels should not be lapped over an opening.

ASSEMBLY DETAILS	OPENING DIMENSIONS (steel to steel)					PACKING DETAILS		LENGTH	MAX. HEIGHT
	ID	HEIGHT	WIDTH	HEAD	SILL	LEFT SIDE	RIGHT SIDE	1198	2710
ASSEMBLED:								DETAILER	DETAILED
FABRICATOR: TRUE STEEL FRAMES								VANTAGE_DS	21-10-2019
CUSTOMER: BERT FARINA CONSTRUCTION								WEIGHT	SCALE
CLIENT REF: 4 REDWOOD ST, ROSTREVOR								14	1:25

DESCRIPTION	Usage	No.	Length	Mat.	Qty
U904475G550	TOPPLATE	001	598	0.75	1
U904475G550	BOTPLATE	002	598	0.75	1
U904475G550	NOGGING	003	588	0.75	1
C9055ra	STUD	100	2706	0.55	1
C9055ra	STUD	101	2706	0.55	2
WALLTITE	SCREW	N/A	-	-	18

Length crib: 2
Floor RL: 3217
INTERNAL wall

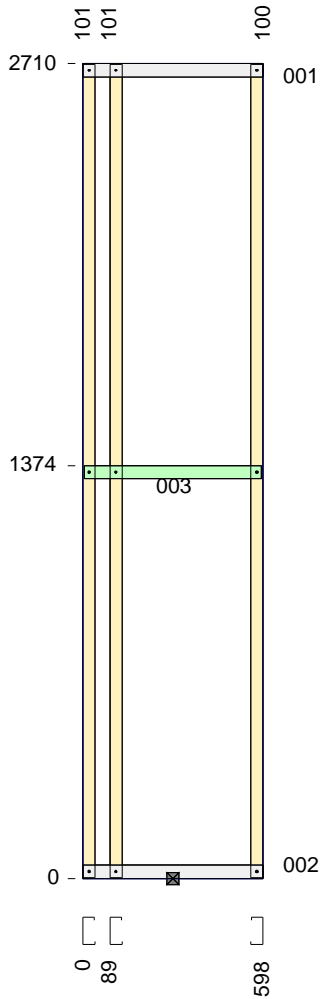

All dimensions to back of section. Where multiple lintels are used in place of a continuous lintel, it should have a minimum lap length of 450mm. Lintels should not be lapped over an opening.

ASSEMBLY DETAILS	OPENING DIMENSIONS (steel to steel)					PACKING DETAILS		LENGTH	MAX. HEIGHT
	ID	HEIGHT	WIDTH	HEAD	SILL	LEFT SIDE	RIGHT SIDE	598	2710
ASSEMBLED: FABRICATOR: TRUE STEEL FRAMES CUSTOMER: BERT FARINA CONSTRUCTION CLIENT REF: 4 REDWOOD ST, ROSTREVOR								DETAILER	DETAILED
								VANTAGE_DS	21-10-2019
								WEIGHT	SCALE
								8	1:25

DESCRIPTION	Usage	No.	Length	Mat.	Qty
U904475G550	TOPPLATE	001	1048	0.75	1
U904475G550	BOTPLATE	002	1048	0.75	1
U904475G550	NOGGING	003	109	0.75	2
U904475G550	HEAD	004	880	0.75	1
C9055ra	STUD	100	2706	0.55	1
C9075ra	STUD	101	2706	0.75	1
C9075ra	STUD	102	296	0.75	1
C9075ra	STUD	103	2706	0.75	1
C9055ra	STUD	104	2706	0.55	1
WALLTITE	SCREW	N/A	-	-	32

Length crib: 2
Floor RL: 3217
INTERNAL wall

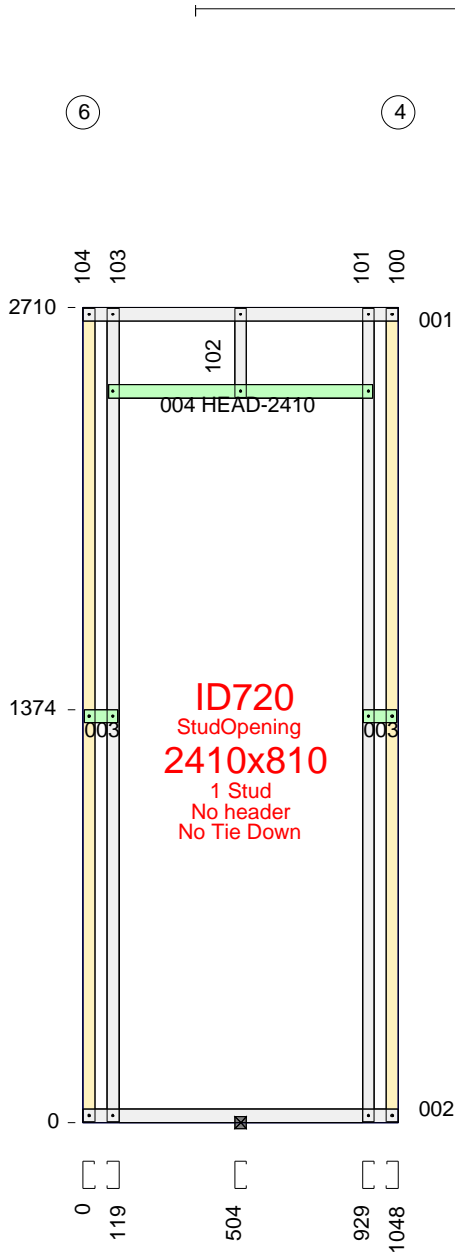

All dimensions to back of section. Where multiple lintels are used in place of a continuous lintel, it should have a minimum lap length of 450mm. Lintels should not be lapped over an opening.

ASSEMBLY DETAILS	OPENING DIMENSIONS (steel to steel)				PACKING DETAILS		LENGTH	MAX. HEIGHT
	ID	MANUF.	CAT NO.	UNIT DIM.	LEFT SIDE	RIGHT SIDE	1048	2710
ASSEMBLED:	D8	STUDOPEN	StudOpening	2410x810			DETAILER	DETAILED
FABRICATOR: TRUE STEEL FRAMES							VANTAGE_DS	21-10-2019
CUSTOMER: BERT FARINA CONSTRUCTION							WEIGHT	SCALE
CLIENT REF: 4 REDWOOD ST, ROSTREVOR							14	1:25

DESCRIPTION	Usage	No.	Length	Mat.	Qty
U904475G550	TOPPLATE	001	598	0.75	1
U904475G550	BOTPLATE	002	598	0.75	1
U904475G550	NOGGING	003	588	0.75	1
C9055ra	STUD	100	2706	0.55	1
C9055ra	STUD	101	2706	0.55	2
WALLTITE	SCREW	N/A	-	-	18

Length crib: 2
Floor RL: 3217
INTERNAL wall

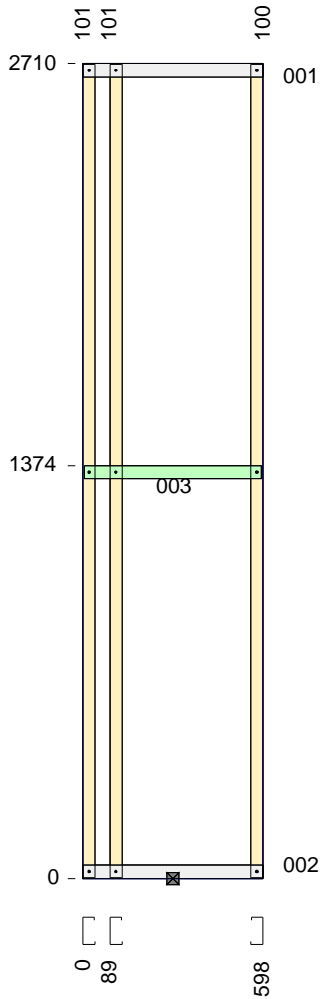

All dimensions to back of section. Where multiple lintels are used in place of a continuous lintel, it should have a minimum lap length of 450mm. Lintels should not be lapped over an opening.

ASSEMBLY DETAILS	OPENING DIMENSIONS (steel to steel)					PACKING DETAILS		LENGTH	MAX. HEIGHT
	ID	HEIGHT	WIDTH	HEAD	SILL	LEFT SIDE	RIGHT SIDE	598	2710
ASSEMBLED: FABRICATOR: TRUE STEEL FRAMES CUSTOMER: BERT FARINA CONSTRUCTION CLIENT REF: 4 REDWOOD ST, ROSTREVOR								DETAILER	DETAILED
								VANTAGE_DS	21-10-2019
								WEIGHT	SCALE
								8	1:25

DESCRIPTION	Usage	No.	Length	Mat.	Qty
U904475G550	BOTPLATE	001	1548	0.75	1
U904475G550	TOPPLATE	002	1189	0.75	1
U904475G550	NOGGING	003	1538	0.75	1
U904475G550	TOPPLATE	004	399	0.75	1
C9075ra	STUD	100	2748	0.75	1
C9055ra	STUD	101	2706	0.55	4
C9075ra	STUD	102	2783	0.75	1
C9075ra	STUD	103	2741	0.75	1
BRA-1.0x30-550	Brace	201	2936	1.0	2
TENSIONER_SET	Tensnr	N/A	0	N/A	2
Washer40x40x5	HOLDDOWN	N/A		5	2745
SCREW-M6-1PX18-TEK	SCREW	N/A	-	-	12
WALLTITE	SCREW	N/A	-	-	44

Length crib: 2
Floor RL: 3217
INTERNAL wall

Screws at each end of BRA-1.0x30-550 = 3

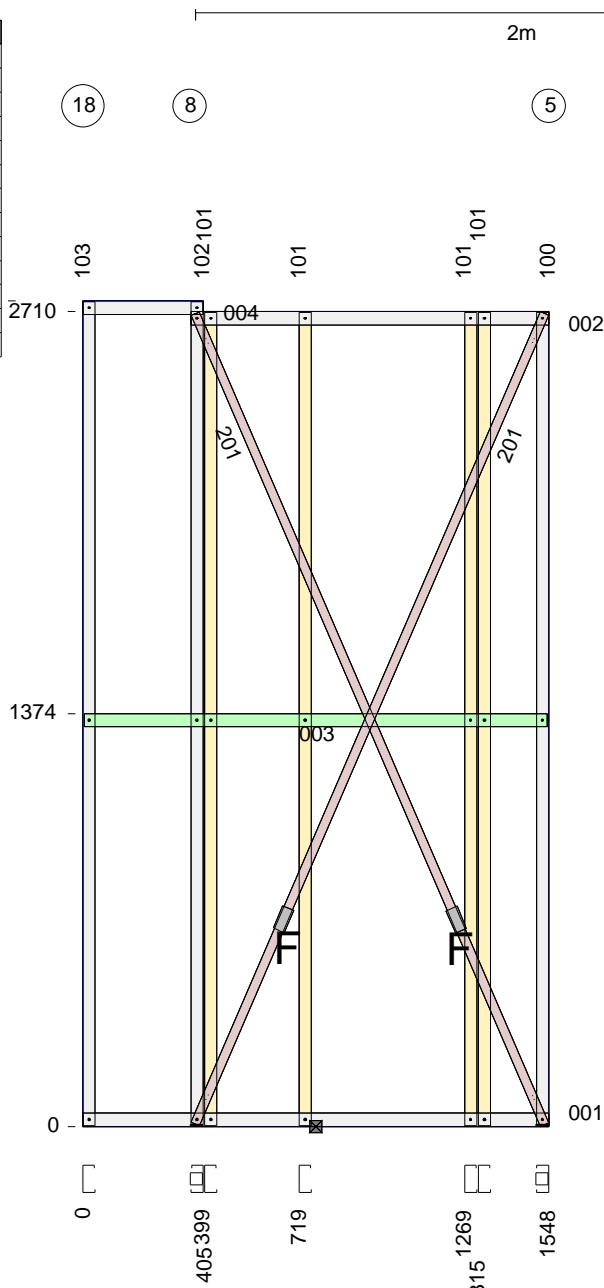

All dimensions to back of section. Where multiple lintels are used in place of a continuous lintel, it should have a minimum lap length of 450mm. Lintels should not be lapped over an opening.

ASSEMBLY DETAILS	OPENING DIMENSIONS (steel to steel)					PACKING DETAILS		LENGTH	MAX. HEIGHT
	ID	HEIGHT	WIDTH	HEAD	SILL	LEFT SIDE	RIGHT SIDE	1548	2745
ASSEMBLED:								DETAILER	DETAILED
FABRICATOR: TRUE STEEL FRAMES								VANTAGE_DS	21-10-2019
CUSTOMER: BERT FARINA CONSTRUCTION								WEIGHT	SCALE
CLIENT REF: 4 REDWOOD ST, ROSTREVOR								24	1:25

DESCRIPTION	Usage	No.	Length	Mat.	Qty
U904475G550	TOPPLATE	001	3183	0.75	1
U904475G550	BOTPLATE	002	3183	0.75	1
C9075ra	STUD	100	214	0.75	2
C9075ra	WEB	201	214	0.75	5
C9075ra	WEB	202	481	0.75	2
C9075ra	WEB	203	518	0.75	4
MULTIGRIP	TIEDOWN	N/A		3	3
SCREW-12-14x20-HEX	SCREW	N/A	-	-	12
SCREW-M6-1PX18-TEK	SCREW	N/A	-	-	6
WALLTITE	SCREW	N/A	-	-	52

Length crib: 2
Floor RL: 3217
INTERNAL wall

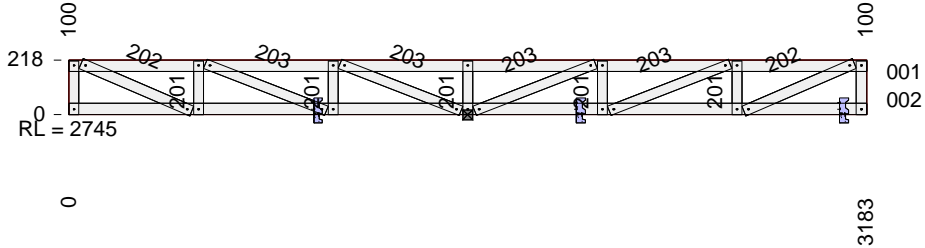

All dimensions to back of section. Where multiple lintels are used in place of a continuous lintel, it should have a minimum lap length of 450mm. Lintels should not be lapped over an opening.

ASSEMBLY DETAILS	OPENING DIMENSIONS (steel to steel)					PACKING DETAILS		LENGTH	MAX. HEIGHT
	ID	HEIGHT	WIDTH	HEAD	SILL	LEFT SIDE	RIGHT SIDE	3183	218
ASSEMBLED: FABRICATOR: TRUE STEEL FRAMES CUSTOMER: BERT FARINA CONSTRUCTION CLIENT REF: 4 REDWOOD ST, ROSTREVOR								DETAILER	DETAILED
								VANTAGE_DS	21-10-2019
								WEIGHT	SCALE
								12	1:30