

NOTES:

1. DOOR ACCESS CONTROL WITHIN STAIRWELL TO BE CONFIGURED AS 'FAIL-SAFE', WITH ELECTRIC STRIKE TO RELEASE ON FIRE ALARM SIGNAL.
2. BALCONY OUTLETS AND EXHAUST FANS WITHIN APARTMENTS TO BE SUPPLIED FROM LOCAL APARTMENT LOAD CENTRE. FAN TO BE SWITCHED FROM 2ND POLE OF LOCAL LIGHT SWITCH. TYPICAL.
3. REFER TO ARCHITECTURAL DOCUMENTATION FOR FULL REQUIREMENTS OF ELECTRICAL INSTALLATION WITHIN APARTMENTS. PROVIDE ALL REQUIRED MATERIALS AND FIXTURES AND INSTALL ACCORDING TO ARCHITECT SET-OUT. TYPICAL.

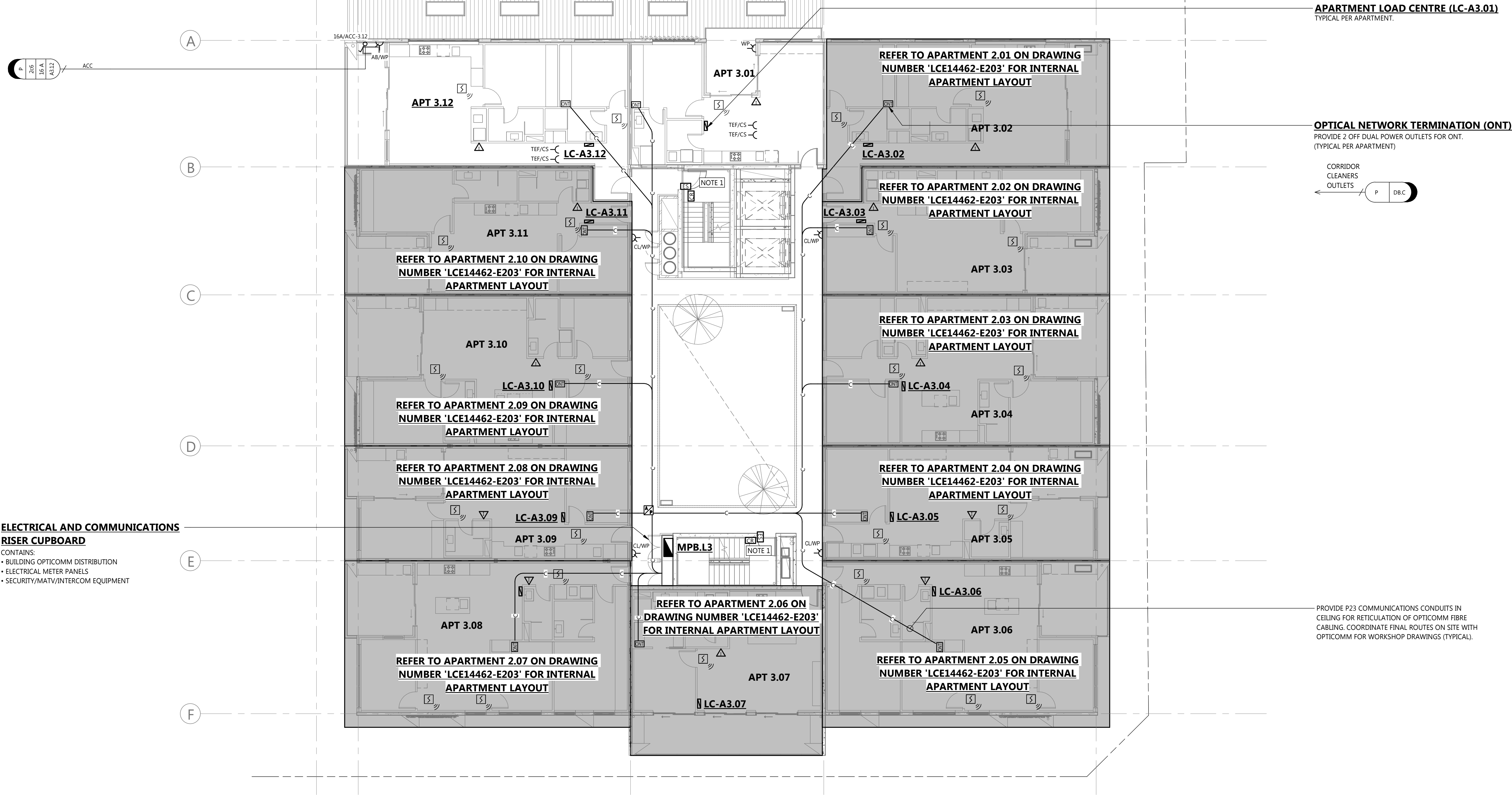

ELECTRICAL AND COMMUNICATIONS
RISER CUPBOARD

- CONTAINS:
- BUILDING OPTICOMM DISTRIBUTION
 - ELECTRICAL METER PANELS
 - SECURITY/MATV/INTERCOM EQUIPMENT

T1	TENDER ISSUE	23.05.19	MS
REV N	DESCRIPTION	DATE	CHKD

TENDER ISSUE

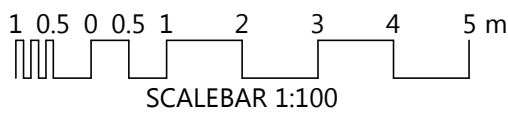

PROJECT
HYDE PARK PLACE
248 UNLEY ROAD, HYDE PARK
ELECTRICAL SERVICES

DRAWING
3RD FLOOR POWER, COMMUNICATIONS AND
SECURITY ARRANGEMENT

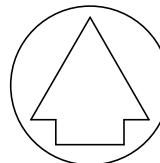

NOT FOR CONSTRUCTION PURPOSES UNLESS STAMPED FOR CONSTRUCTION. VERIFY DIMENSIONS AND LEVELS ON SITE BEFORE SETTING OUT. DO NOT SCALE. REFER TO FIGURED DIMENSIONS - IN mm UNLESS OTHERWISE STATED.			
Scale	Design: MD	No. in Set	Date
1 : 100	Drawn: PY	9 of 24	MAY 2019
Orig. Size	Drawing no.	Revision	
A1	LCE14462-E204	T1	