

3RD FLOOR STEEL COLUMN SCHEDULE		
MARK	SIZE	REMARKS
3C1	150x9.0 SHS	COLUMN. 12 THK BASE/CAP PLATE WELDED TO COLUMN, 4M20 8.8/S BOLTS.

3RD FLOOR STEEL FRAMING SCHEDULE		
MARK	SIZE	REMARKS
3B1	200UC59.5	CONTINUOUS FLOOR BEAM OVER TOP OF COLUMNS. 4M20 8.8/S BOLTS TO COLUMN CAP PLATE. PROVIDE 2 ROWS OF 12 THICK STIFFENERS BOTH SIDES OF WEB, IN LINE WITH COLUMN EDGES
3B2	310UC158	CONTINUOUS FLOOR BEAM. REFER TO DETAIL ON DRAWING S34.
3B3	250 PFC	CANTILEVER FLOOR BEAM. REFER TO TYPICAL DETAIL ON DRAWING S33.
3B4	200UC59.5	10 THK CLEAT SITE WELDED TO 12 THK CAST IN PLATE WITH 2N20 RAG BARS 150 LONG + 200 COG. 2M20 8.8/S BOLTS TO BEAM
3B5	250UC72.9	CONTINUOUS FLOOR BEAM OVER TOP OF COLUMNS. 4M20 8.8/S BOLTS TO COLUMN CAP PLATE. PROVIDE 2 ROWS OF 12 THICK STIFFENERS BOTH SIDES OF WEB, IN LINE WITH COLUMN EDGES
3B6	250UC72.9	BEAM.
3B7	180 PFC + 200 x12 THK PL.	BEAM.
3GP1	SC15015	GUTTER PURLIN.
3P1	SZ15015	PURLINS @ 1200 CTS. 8 THK CLEAT PLATE, 2M12 4.6/S BOLTS.
3R1	200 PFC	RAFTER. REFER DETAIL ON DRG. 20492-S34.
3WA1	150x12 EA	WALL ANGLE. FIX TO PRECAST PANEL WITH M20 8.8/S BOLTS INTO CAST-IN FERRULES AT 600 CTS. (typ.)
3WA2	150x90x8 UA	WALL ANGLE. FIX TO PRECAST PANEL WITH 2M20 8.8/s BOLTS INTO CAST-IN FERRULES. REFER TO TTYPICAL DETAIL ON DRAWING 20492-S33
4WA1	150x12 EA	WALL ANGLE. FIX TO PRECAST PANEL WITH M20 8.8/S BOLTS INTO CAST-IN FERRULES AT 600 CTS. (typ.)
5WA1	150x12 EA	WALL ANGLE. FIX TO PRECAST PANEL WITH M20 8.8/S BOLTS INTO CAST-IN FERRULES AT 600 CTS. (typ.)
6WA1	150x12 EA	WALL ANGLE. FIX TO PRECAST PANEL WITH M20 8.8/S BOLTS INTO CAST-IN FERRULES AT 600 CTS. (typ.)
LT1	180 PFC	FIXED TO FACE OF PRECAST PANEL WITH 10 THK. CLEAT PLATE & 2M16 8.8/s BOLTS INTO CAST-IN. FIXED TO RAFTER AT EACH END WITH 10 THK. CLEAT CLEAT & 2M16 8.8/s BOLTS

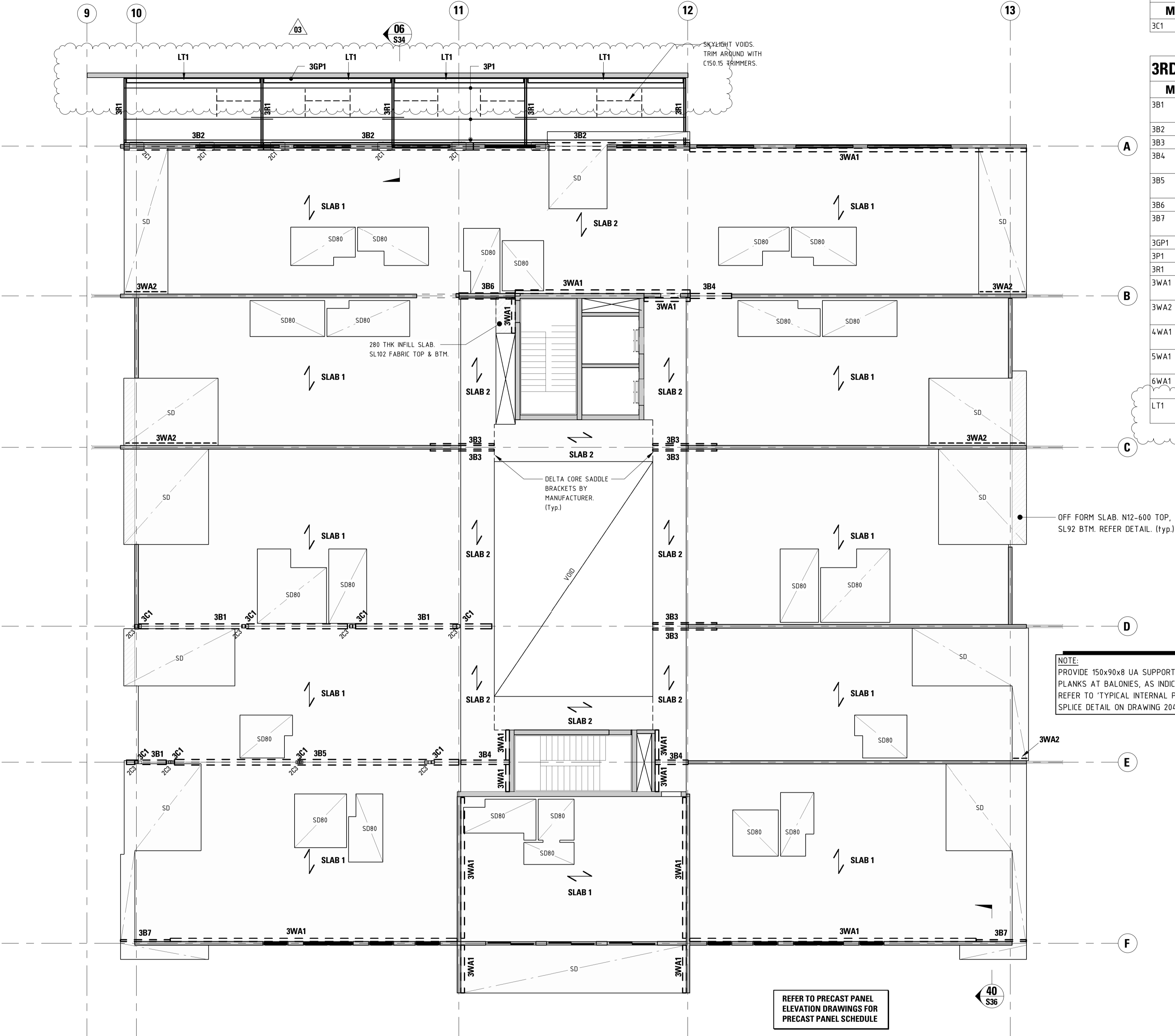

THIRD FLOOR LAYOUT PLAN  
SCALE 1:100

**NOTES:**  
PROVIDE 80mm THICK TOPPING SLAB (32MPa), REINFORCED WITH SL92 FABRIC TOP THROUGHOUT, UNLESS NOTED OTHERWISE. ALTERNATIVELY USE FIBRE REINFORCED TOPPING SLAB WITH 'SIKA FIBRE PPM48/19 ', IN LIEU OF SL92 FABRIC, AT DOSAGE RATE OF 4.6 kg/m3.  
**NOTE:**  
FINAL DOSAGE MUST BE CONFIRMED BY CONCRETE SUPPLIER AT TIME OF MIX DESIGN. PROVIDE 80mm MIN. END BEARING TO DELTACORE PLANKS.

**LEGEND:**  
◊ DENOTES COLUMN ABOVE (BOLD TEXT)  
◊ DENOTES COLUMN UNDER  
↗ DENOTES SPAN DIRECTION.  
**SLAB 1** HOLLOWCORE HC200.12 (0,5)  
**SLAB 2** HOLLOWCORE HC200.12 (2,7)  
**NOTE:**  
ALL HOLLOWCORE TOP STRANDS TO BE 9.3 Dia. & BTM. STRANDS TO BE 12.7 Dia.  
SD DENOTES 80mm SLAB SETDOWN. REFER TO ARCH. DWG. FOR SETOUT

FOR CONSTRUCTION

07.05.20	REVISIONS AS CLOUDED	03
Date	Revision	Issue

PT Design

PT Design Associates Pty Ltd 141-149 Hould St Adelaide SA 5000  
T [08 8412 4300] F [08 8232 4311] E [ptdesign@ptdesign.net.au]

Designer	RW	Drawn	BZ & MM
Approved	Approver	Date	07/05/2020 9:33:28 AM
		Sheet	

Project <b>HYDE PARK PLACE 248 UNLEY ROAD, HYDE PARK SA</b>		<div>N</div> <div><div></div><div>+</div><div></div></div>
Client <b>CITIFY &amp; BFC PTY LTD</b>		
Drawing Title <b>3RD FLOOR LAYOUT PLAN</b>		Scale <div>As indicated</div>
Drawing Number <b>20492-S08</b>		Issue <b>03</b>

Name: P:\2018\20492\3.5 Drawings  
[S]Revit 2019\Local files\20492 -  
Structural Model\_1\_Maurice.rvt  
Date/Time 07/05/2020 9:33:28 AM  
© Copyright