

MARION ROAD

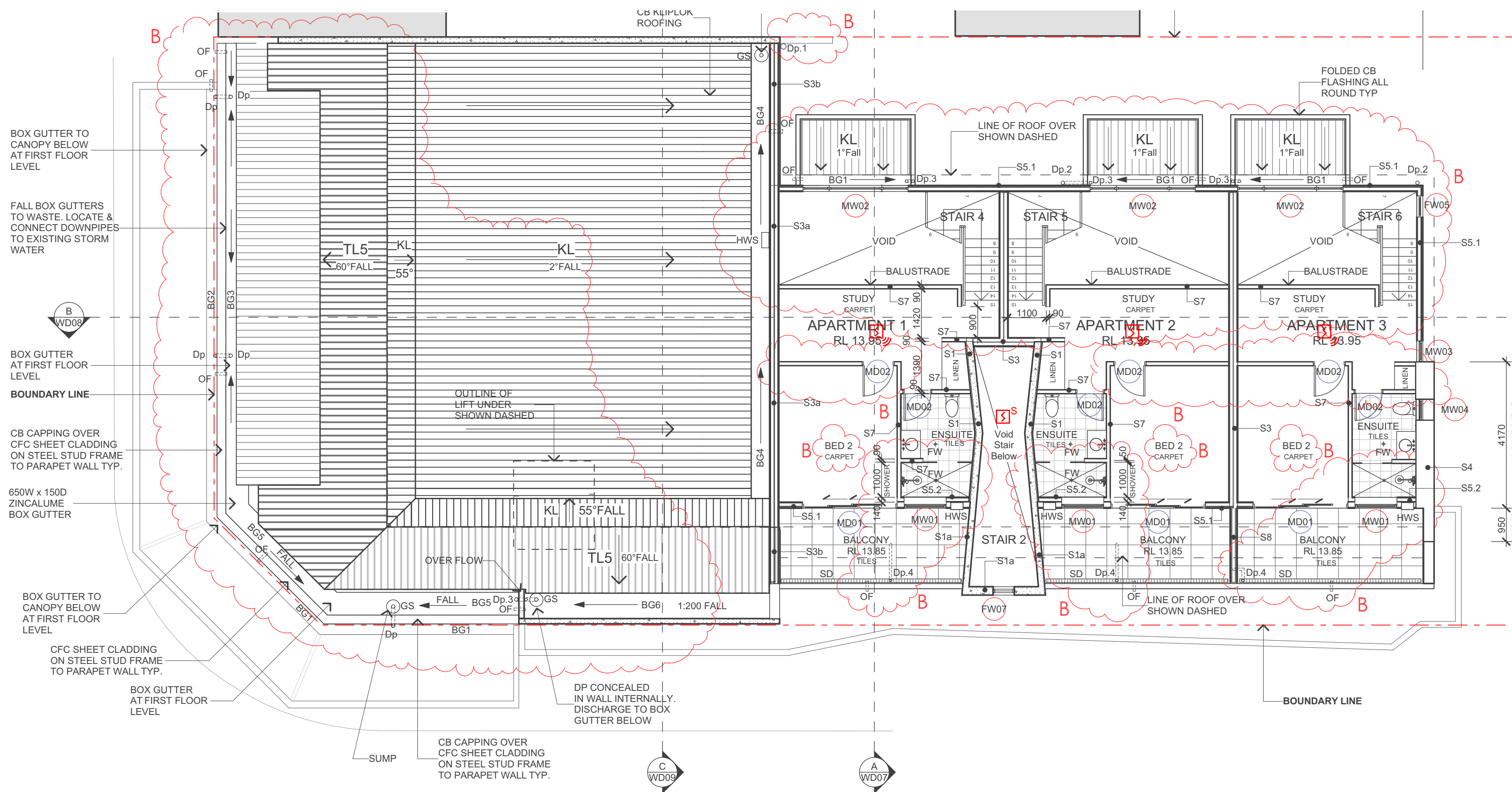

MEZZANINE FLOOR FIRE SERVICES ARRANGEMENT
SCALE 1:100

LANE STREET

SPECIFICATION NOTES :

1.GENERAL

- ALL WORKS SHALL BE CARRIED OUT IN ACCORDANCE WITH THE BCA, DEVELOPMENT ACT 1993 AND DEVELOPMENT REGULATIONS 2008, OCCUPATIONAL HEALTH AND WELFARE REGULATIONS AND CURRENT STATUTORY CODES APPLICABLE TO THE SYSTEMS NOMINATED.
- COMPLY WITH THE TENDER CONDITIONS AND PRELIMINARIES OF THE CONTRACT.
- SITE MEASURE AND COORDINATE ALL ASPECTS OF THE WORKS WITH ALL OTHER SERVICES AND STRUCTURE.
- COORDINATE ALL PIPEWORK AND EQUIPMENT WITH LIGHTS, CABLE TRAYS, PIPES, STRUCTURE, DUCTWORK AND ALL OTHER SERVICES.
- PROVIDE 3 (THREE) COPIES OF WORKSHOP DRAWINGS, INCLUDING DETAILS AND SPACING OF SUPPORT BRACKETS PRIOR TO CONSTRUCTION. CONSTRUCTION SHALL NOT COMMENCE UNTIL WORKSHOP DRAWINGS ARE REVIEWED AND A FORMAL INSTRUCTION TO PROCEED IS RECEIVED.
- AS INSTALLED DRAWINGS SHALL BE PREPARED ON AUTOCAD 2004 OR ABOVE, FOLLOWING A DETAILED SITE COORDINATION OF FINAL EQUIPMENT/SYSTEM LOCATIONS. DRAWINGS SHALL BE PROVIDED AT A SCALE OF 1:100 FOR LAYOUTS, 1:20 FOR DETAILS AND 1:500 FOR SITE PLAN.
- INCLUDE FOR ALL PAINTING AND FINISHES:
 - SYSTEMS AND RETICULATION OF SERVICES TO BE IDENTIFIED TO AS 1345.
 - ALL EXPOSED EXTERNAL PIPEWORK TO BE PAINTED TO ARCHITECT'S REQUIREMENTS.
- PROVIDE BLOCK PLANS AND LOG BOOKS AS REQUIRED FOR SYSTEMS INSTALLATION COMPLIANCE ASSOCIATED WITH TESTING, MONITORING AND MAINTENANCE.
- INCLUDE PAYMENT OF AUTHORITIES FEES AND CHARGES AS NECESSARY FOR SUPPLY, TESTING AND COMMISSIONING OF SYSTEMS.
- INCLUDE FULL TESTING AND COMMISSIONING.
- AT PRACTICAL COMPLETION PROVIDE 2 (TWO) COMPLETED COPIES OF "AS INSTALLED" DRAWINGS TO BE INSTALLED WITHIN OPERATING AND MAINTENANCE MANUALS. PROVIDE DRAWINGS IN AUTOCAD AND PDF FORMATS ON A CD ALSO.
- INCLUDE WARRANTY AND DEFECTS LIABILITY FOR A PERIOD OF 12 MONTHS FROM THE DATE OF PRACTICAL COMPLETION. STATUTORY MAINTENANCE IS TO BE PROVIDED FOR TENANCY PORTABLE FIRE EXTINGUISHERS AND FIRE BLANKETS ONLY AS MAINTENANCE OF OTHER SYSTEMS IS THE RESPONSIBILITY OF THE BASE BUILDING CONTRACTOR.
- PROVIDE CERTIFICATE OF COMPLIANCE ASSOCIATED WITH ALL FIRE SERVICES WORKS.
- PROVIDE ELECTRICAL CERTIFICATE OF COMPLIANCE ASSOCIATED WITH ALL ELECTRICAL WORKS.
- PROVIDE FORM 2 CERTIFICATION UPON COMPLETION OF WORKS, AS REQUIRED UNDER THE DEVELOPMENT REGULATIONS 2008.
- PROVIDE FORM 3 CERTIFICATION UPON COMPLETION OF DEFECTS WARRANTY PERIOD IN ACCORDANCE WITH SCHEDULE 16 DEVELOPMENT ACT AND REGULATIONS AND ESSENTIAL SAFETY PROVISIONS FOR THE BUILDING.

2.SCOPE OF WORKS

- UNDERTAKE THE FOLLOWING WORKS:
- PROVIDE SMOKE DETECTION SYSTEM TO SUIT PROPOSED WORKS.

3.SMOKE DETECTION

- SUPPLY AND INSTALL, OR MODIFY EXISTING SMOKE DETECTION SYSTEM INSTALLED TO THE REQUIREMENTS OF AS1670 AND BCA. ANY NEW DETECTORS SHALL BE CAPABLE OF BEING INTERFACED WITH THE EXISTING FIRE INDICATOR PANEL.
- ALLOW TO CONFIRM FIRE INDICATOR PANEL AND EXISTING BLOCK PLANS DURING THE TENDER PERIOD TO VERIFY THAT THE EXISTING SYSTEMS HAVE SUFFICIENT CAPACITY TO CONNECT TO ADDITIONAL DEVICES.
- ALLOW TO PROVIDE 2 (TWO) ADDITIONAL DETECTOR HEADS IN ADDITION TO THOSE NOMINATED ON THE DRAWINGS.
- ALL CABLING TO EXPOSED SLAB THERMAL AND SMOKE DETECTORS SHALL BE INSTALLED IN CONDUITS CAST INTO SLAB.
- SMOKE DETECTORS SHALL BE POSITIONED A MINIMUM OF 400mm FROM A WALL, CEILING BULKHEAD, CEILING FAN OR DUCTWORK OUTLET.
- THE FIRE DETECTION SYSTEM SHALL COMPLY WITH BCA SPECIFICATION E2.2 AND REFERENCE STANDARD AS 1670.1.

4.OCCUPANT WARNING

- CEILING SPEAKERS SHALL COMPLY WITH THE FOLLOWING REQUIREMENTS:
 - 5W MINIMUM RATED CAPACITY WITH MULTIPLE TAPPINGS.
 - 105dB(A), MAXIMUM OUTPUT @ 1 METRE.
 - 100mm DIAMETER, 100V DC.
- CARRY OUT SOUND LEVEL TESTS AND SPEECH INTELLIGIBILITY TESTS AND SUPPLY RESULTS INDICATORS WITHIN OCCUPIED AREAS IN ACCORDANCE WITH AS 1670.4.
- ALLOW TO REVIEW MASTER EVACUATION CONTROL PANEL CAPACITY DURING THE TENDER PERIOD TO CONFIRM THAT THE EXISTING PANEL HAS SUFFICIENT CAPACITY TO UNDERTAKE THE PROPOSED WORKS.

5.technical data

- AS PART OF THE TENDER SUBMISSION, ALLOW TO PROVIDE THE FOLLOWING INFORMATION:
- PROPOSED SMOKE DETECTOR MAKE/MODEL (BELOW CEILING).
 - PROPOSED SMOKE DETECTOR MAKE/MODEL (ABOVE CEILING).
 - PROPOSED THERMAL DETECTOR MAKE/MODEL (BELOW CEILING).
 - PROPOSED THERMAL DETECTOR MAKE/MODEL (ABOVE CEILING).
 - UNIT RATE FOR BELOW CEILING DETECTOR INCLUDING SUPPLY AND INSTALLATION.
 - UNIT RATE FOR ABOVE CEILING DETECTOR INCLUDING SUPPLY AND INSTALLATION.

CONSTRUCTION ISSUE

REV	DESCRIPTION	DATE	CHK'D
A	CONSTRUCTION ISSUE	23.01.18	TT
 Level 3/169 Pirie St Adelaide SA 5000 Phone: (08) 8407 9700 Email: adelaide@lucidconsulting.com.au			
CLIENT 			
PROJECT 147 MARION ROAD, RICHMOND			
DRAWING MEZZANINE FLOOR FIRE SERVICES ARRANGEMENT AND SPECIFICATION NOTES			
FIRE SERVICES			
SCALE	1:100 @ A1	DATE	JAN 2018
DESIGNED	PC/JZ	DRAWN	JZ
DRAWING NUMBER	LCE12474-SKF03	No. IN SET	3 OF 3
REVISION			A